



Australia's Safest Tanks and Trailers

2018

Product Catalogue



Distributed by

0508 044 055
www.condorpumps.co.nz



Valid from 1st January 2018



WATER CARTAGE TANKS



DIESEL TRANSFER UNITS



YARD WATERING UNITS



WASH DOWN UNITS



CHEMICAL CARTAGE TANKS



DIESEL TRAILERS TRAILERS



DUST SUPPRESSION



WASH DOWN TRAILERS



WELCOME TO THE **2018** CATALOGUE

Dear Customer,

Welcome to the 2018 edition of TTi's comprehensive range of products.

Trans Tank® International (TTi) is based in Northern Victoria, Australia, where they have been manufacturing rotationally moulded polyethylene tanks for nearly 20 years. Condor Pumps identified a need in the New Zealand market for high quality, globally recognised rotational moulded transport tanks that could withstand heavy use and replace the traditional steel tanks that have been used up until now in NZ.

Condor Pumps has partnered with TTi as an exclusive agent for New Zealand bringing the Trans Tank® International (TTi) range to the Civil and Farming markets as a dedicated distributor with our Head Office in Wellington and a dedicated team offering support and expertise throughout the country.

TTi's unmatched experience in the industry is reflected in the presentation and functionality of the product range.

Thank you again, we sincerely look forward to working with you.

Joseph Cashmore

Condor Pumps - New Zealand

PRODUCT CATEGORIES



Tanks
Water / Chemical

p07



Diesel
Transport Equipment

p27



Wash Down
Unit / Equipment

p39



Industrial
Equipment

p50



MOULDING



FABRICATION



PRODUCTION



WAREHOUSE





TANKS

Distributed by
CONDOR

www.condorpumps.co.nz | 0508 044 055 | sales@condorpumps.co.nz



2018

Product Catalogue



DIFFERENCES BETWEEN **AQUAMOVE** AND **AQUATRANS**

There is nothing much in the way of a rotationally moulded polyethylene water cartage tank that compares with the **TTi AquaTrans tank range**. A really heavy-duty tank with a 20 year warranty is just part of the deal. The **Aquatrans** is a **premium product** and is in a league of its own. ***This is the bees' knees!***

Without any compromise, the **AquaMove range** has been introduced to be a player in the price sensitive end of the market. With a slightly lighter design than the AquaTrans and a 15 year warranty, **this is the everyday range**.

ENQUIRE Now!
0508 044 055

HEAVY DUTY WATER CARTAGE TANKS

Easy fill, **no spill containment** lip on tanks over 400 Litres

Large tank opening for fast, easy filling. Sealed with **455mm lid with labyrinth breather**

All tanks are **cooked to temperature**, not time

Extra thick tank structure with a load capacity of up to an enormous 1:1.3 Specific Gravity on all on all AquaTrans



Exclusive, **specially developed** and formulated **polyethylene** incorporating our "**Tuff-Flex Molecular Technology**" ideal for safe & secure transporting

Easy to read **calibration on side wall** of tank for quick measurement of contents (when sight level tube fitted on tank under 6000 litres)

Specifically designed footings to enable easy mounting to any flat surface - mounting pins included.

ORDER with **BALL BAFFLES** to reduce surge & **INCREASE STABILITY**



UV stabilised to withstand the elements

Free **outlet fitted** with every tank

SureFit Tank securing kit available for all water cartage tanks



WATER & FOAM TANKS

- » Impact **resistant**
- » Space **saving** profile
- » UV **stabilised** for years of use
- » **Moulded** inserts for mounting
- » Tanks can be **drilled and tapped** to accept fittings
- » **Extra thick** structure for handling pressure up to 4 psi



10 LITRE WATER TANK
CODE: PTZV00010SG
220mm(ø) x 460mm(H)

\$192



35 LITRE WATER TANK
CODE: PTZV00025SG
450mm(ø) x 400mm(H)

\$258



50 LITRE WATER TANK
CODE: PTZV00050SG
450mm(ø) x 600mm(H)

\$380

450mm lid option available



100 LITRE WATER TANK
CODE: PTZV00100SG
450mm(ø) x 950mm(H)

\$587

450mm lid option available



35 LITRE FOAM TANK
CODE: PTZB00025SG
450mm(ø) x 400mm(H)

\$382



50 LITRE FOAM TANK
CODE: PTZB00050SG
450mm(ø) x 600mm(H)

\$512



100 LITRE FOAM TANK
CODE: PTZB00100SG
450mm(ø) x 950mm(H)

\$698

WATER CARTAGE TANKS



AquaTrans
MOVING LIQUID SOLUTIONS

www.condorpumps.co.nz | 0508 044 055 | sales@condorpumps.co.nz

All prices exclude GST

20L



20L AquaTrans

CODE: PTC00020SG

\$249

- » ø100 Lid & Seal
- » ¾" Poly Drain Bung & Seal
- » 590(L) x 320(W) x 280(H)

50L



50L AquaTrans

CODE: PTC00050SG

\$413

- » ø150 Lid & Seal
- » ¾" Poly Drain Bung & Seal
- » 800(L) x 430(W) x 390(H)

100L



100L AquaTrans

CODE: PTC00100SG

\$622

- » ø150 Lid & Seal
- » ¾" Poly Drain Bung & Seal
- » 900(L) x 450(W) x 475(H)

200L



200L AquaTrans

CODE: PTC00200SG

\$698

- » ø150 Lid & Seal
- » ¾" Poly Drain Bung & Seal
- » 1000(L) x 650(W) x 600(H)

220L



220L AquaTrans

CODE: PTC00220SG

\$713

- » ø255 Lid Assembly
- » ¾" Poly Drain Bung & Seal
- » 925(L) x 710(W) x 510(H)

400L



400L AquaTrans

CODE: PTC00400ASG

\$1,305

- » ø255 Lid Assembly
- » ¾" Poly Drain Bung & Seal
- » 1620(L) x 710(W) x 510(H)

CODE	STEEL FRAME	RRP(\$)
SSF001	Top Mount Steel Pump Plate	\$357.5
ASFD00220	Steel Skid Frame	\$668.2



220L Sample Tank Application

CODE	STEEL FRAME	RRP(\$)
SSF001	Top Mount Steel Pump Plate	\$357.5
ASFD00400A	Steel Skid Frame	\$668.2

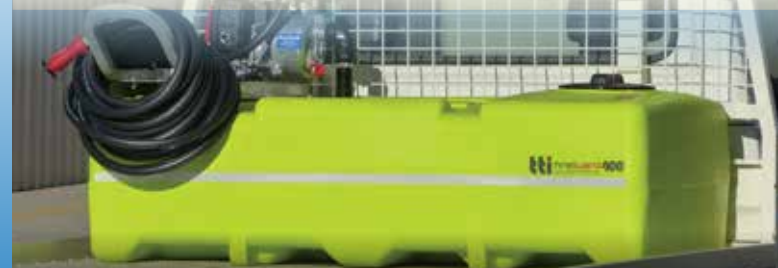

400L Sample Tank Application

eliminate surge In Your tank

Complies with load restraint guide performance standards

Reduces fluid movement for improved load stability during transit

Suitable for use with all tanks - poly, steel, fibreglass, aluminium, etc.

Food grade quality material - suitable for potable water

Ball Baffles can be used with water, diesel and other liquids

Simple to install - Balls are supplied in two halves and require a quick click n' twist clipping together and inserting through lid into tank

No rust, lightweight & durable

Low liquid displacement

With the **Safety Ball Baffle system**

Guaranteed **STRENGTH** with **EXTRA THICK** structure



See product in action!



See product instructions



Designed to **reduce LIQUID SURGE**

IMPROVE SAFETY with our **BALL BAFFLE SYSTEM**

Ball Baffles

ø195mm (Small)

1 ball per 7 Litres

Code: ARB195

\$6.63

Ball Baffles

ø355mm (Large)

1 ball per 40 Litres

Code: ARB355

\$11.64



WATER CARTAGE TANKS

tti AquaTrans/Move
MOVING LIQUID SOLUTIONS

500L

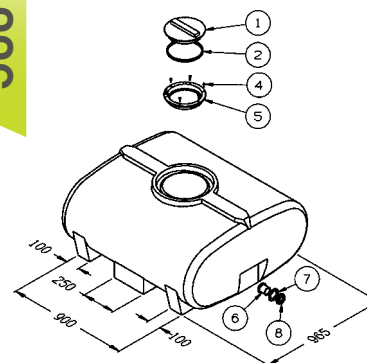

1» ø255 Lid Seal Only

2-5» ø255 Lid, Rim, & Seal Assy

4» Stainless Steel Screws

6-8» 1½" MBSP Fitting-Poly (fitted)

» 1250(L) x 1070(W) x 580(H)



CODE	TANK OPTIONS	RRP(\$)
PTC00500SG	AquaTrans 500L - 20 year Warranty	\$1,433

600L

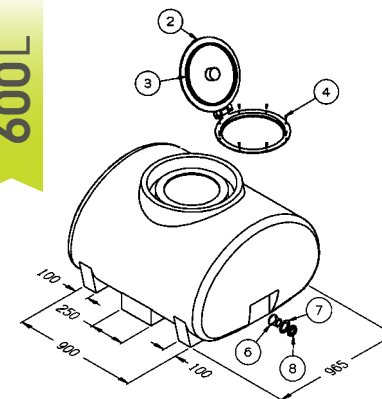

2» ø455 Lid Seal Only

3» ø455 Lid, Rim, & Seal Assy

4» Stainless Steel Screws

6-8» 1½" MBSP Fitting-Poly (fitted)

» 1250(L) x 1070(W) x 740(H)



CODE	TANK OPTIONS	RRP(\$)
PTC00600SG	AquaTrans 600L - 20 year Warranty	\$1,574

QTY	BAFFLES	RRP(\$)
71	Ball baffles supplied not fitted	\$470
71	Ball baffles fitted at factory	\$562

CODE	STEEL MOUNTING FRAME	RRP
N/A	N/A	N/A

QTY	BAFFLES	RRP(\$)
15	Ball baffles supplied not fitted	\$172
15	Ball baffles fitted at factory	\$193

CODE	STEEL MOUNTING FRAME	RRP
N/A	N/A	N/A

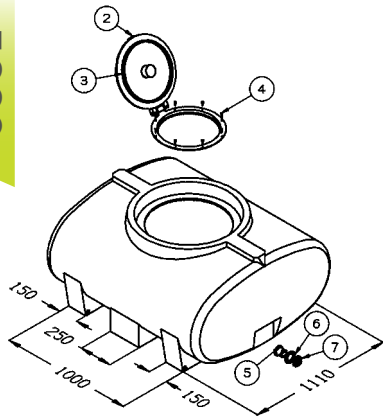
See **page 17** for **steel frame options****800L**

- 2» ø455 Lid Seal Only
 3» ø455 Lid, Rim, & Seal Assy
 4» Stainless Steel Screws
 5-7» 1½" MBSP Fitting-Poly (fitted)
 » 1430(L) x 1220(W) x 670(H)

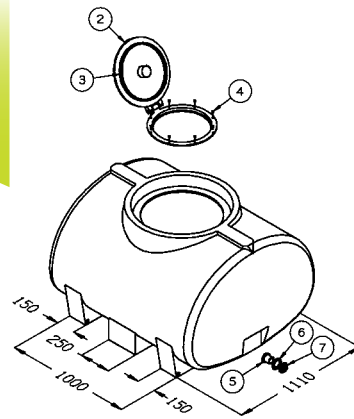
**1000L**

- 2» ø455 Lid Seal Only
 3» ø455 Lid, Rim, & Seal Assy
 4» Stainless Steel Screws
 5-7» 1½" MBSP Fitting-Poly (fitted)
 » 1430(L) x 1220(W) x 835(H)

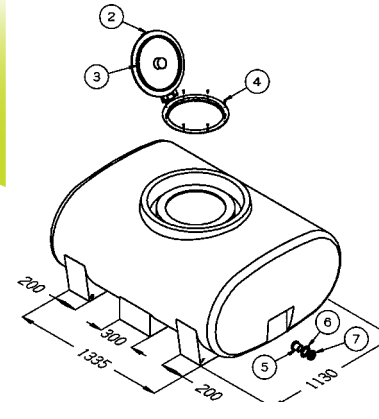
**1200L**

- 2» ø455 Lid Seal Only
 3» ø455 Lid, Rim, & Seal Assy
 4» Stainless Steel Screws
 5-7» 1½" MBSP Fitting-Poly (fitted)
 » 1720(L) x 1230(W) x 840(H)

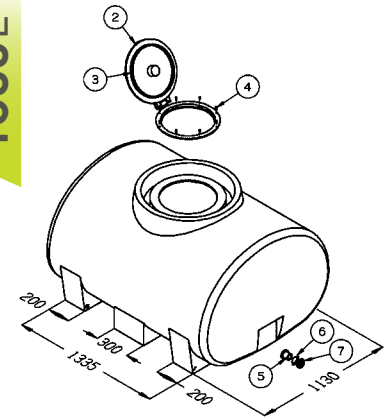
**1500L**

- 2» ø455 Lid Seal Only
 3» ø455 Lid, Rim, & Seal Assy
 4» Stainless Steel Screws
 5-7» 1½" MBSP Fitting-Poly (fitted)
 » 1720(L) x 1230(W) x 1000(H)



CODE	TANK OPTIONS	RRP(\$)
PTC00800SG	AquaTrans 800L - 20 year Warranty	\$1,942

CODE	TANK OPTIONS	RRP(\$)
PTC01000SG	AquaTrans 1000L - 20 year Warranty	\$2,132

CODE	TANK OPTIONS	RRP(\$)
PTC01200SG	AquaTrans 1200L - 20 year Warranty	\$2,288

CODE	TANK OPTIONS	RRP(\$)
PTC01500SG	AquaTrans 1500L - 20 year Warranty	\$2,814

QTY	BAFFLES	RRP(\$)
20	Ball baffles supplied not fitted	\$232
20	Ball baffles fitted at factory	\$258

QTY	BAFFLES	RRP(\$)
25	Ball baffles supplied not fitted	\$291
25	Ball baffles fitted at factory	\$323

QTY	BAFFLES	RRP(\$)
30	Ball baffles supplied not fitted	\$349
30	Ball baffles fitted at factory	\$388

QTY	BAFFLES	RRP(\$)
37	Ball baffles supplied not fitted	\$430
37	Ball baffles fitted at factory	\$478

CODE	STEEL MOUNTING FRAME	RRP(\$)
N/A	N/A	N/A

CODE	STEEL MOUNTING FRAME	RRP(\$)
N/A	N/A	N/A

CODE	STEEL MOUNTING FRAME	RRP(\$)
N/A	N/A	N/A

CODE	STEEL MOUNTING FRAME	RRP(\$)
N/A	N/A	N/A

get any tank in your corporate COLOUR



STANDARD



Safety Green
(opaque)



Natural



Trans Yellow



Trans Blue

OPAQUE



White



Birch Grey



Black



Heritage Green



Yellow



Orange



Red



Dark Blue

WATER CARTAGE TANKS

tti AquaTrans/Move
MOVING LIQUID SOLUTIONS

2000L

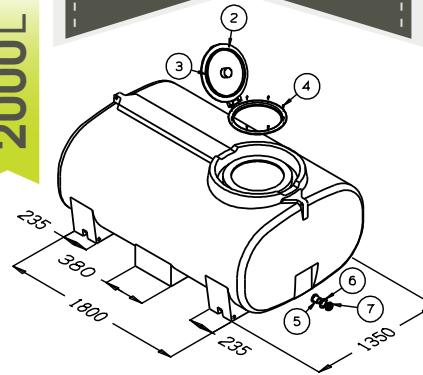

- 2» Ø455 Lid Seal Only
- 3» Ø455 Lid, Rim, & Seal Assy
- 4» Stainless Steel Screws
- 5-7» 2" MBSP Fitting-Poly (fitted)
- » 2150(L) x 1410(W) x 870(H)



CODE	TANK OPTIONS	RRP(\$)
PTC02000SG	AquaTrans 2000L - 20 year Warranty	\$3,703

2400L

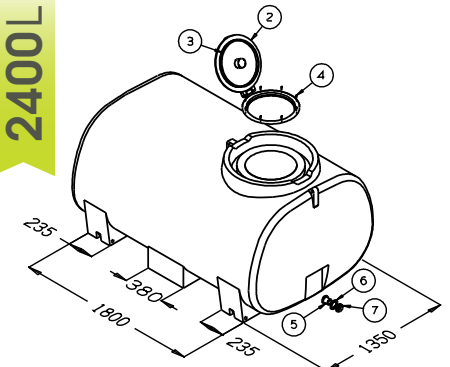

- 2» Ø455 Lid Seal Only
- 3» Ø455 Lid, Rim, & Seal Assy
- 4» Stainless Steel Screws
- 5-7» 2" MBSP Fitting-Poly (fitted)
- » 2150(L) x 1410(W) x 1140(H)



CODE	TANK OPTIONS	RRP(\$)
PTC02400SG	AquaTrans 2400L - 20 year Warranty	\$4,213

QTY	BAFFLES	RRP(\$)
50	Ball baffles supplied not fitted	\$582
50	Ball baffles fitted at factory	\$647

CODE	STEEL MOUNTING FRAME	RRP(\$)
ASFC02000	with Pump Plate - forklift pockets	\$2,425

QTY	BAFFLES	RRP(\$)
60	Ball baffles supplied not fitted	\$698
60	Ball baffles fitted at factory	\$776

CODE	STEEL MOUNTING FRAME	RRP(\$)
ASFC02000	with Pump Plate - forklift pockets	\$2,425

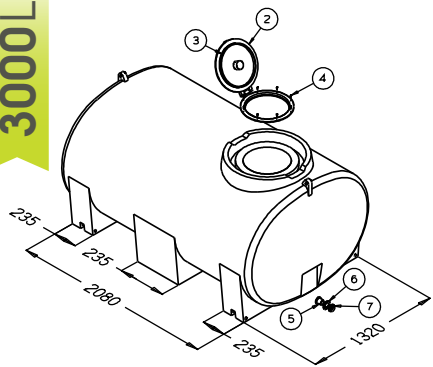
3000L

- 2» ø455 Lid Seal Only
- 3» ø455 Lid, Rim, & Seal Assy
- 4» Stainless Steel Screws
- 5-7» 2" MBSP Fitting-Poly (fitted)
- » 2430(L) x 1540(W) x 1200(H)

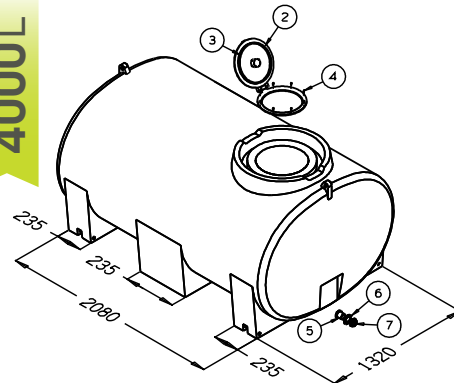
4000L

- 2» ø455 Lid Seal Only
- 3» ø455 Lid, Rim, & Seal Assy
- 4» Stainless Steel Screws
- 5-7» 2" MBSP Fitting-Poly (fitted)
- » 2430(L) x 1540(W) x 1450(H)

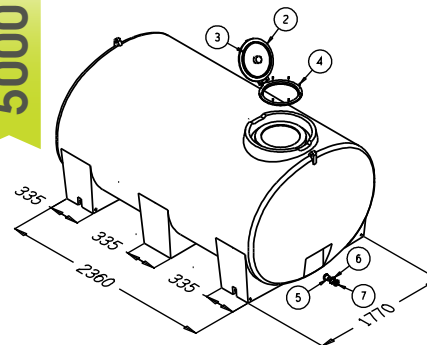
5000L

- 2» ø455 Lid Seal Only
- 3» ø455 Lid, Rim, & Seal Assy
- 4» Stainless Steel Screws
- 5-7» 2" MBSP Fitting-Poly (fitted)
- » 2760(L) x 2000(W) x 1400(H)

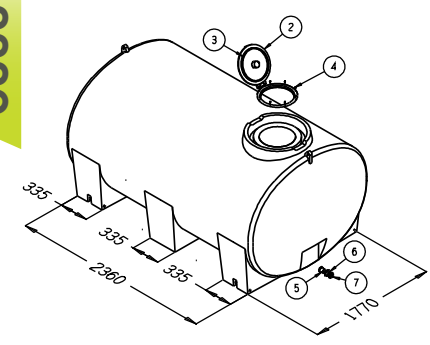
6000L

- 2» ø455 Lid Seal Only
- 3» ø455 Lid, Rim, & Seal Assy
- 4» Stainless Steel Screws
- 5-7» 2" MBSP Fitting-Poly (fitted)
- » 2760(L) x 2000(W) x 1540(H)



CODE	TANK OPTIONS	RRP(\$)
PTC03000SG	AquaTrans 3000L - 20 year Warranty	\$5,517

CODE	TANK OPTIONS	RRP(\$)
PTC04000SG	AquaTrans 4000L - 20 year Warranty	\$6,455

CODE	TANK OPTIONS	RRP(\$)
PTC05000SG	AquaTrans 5000L - 20 year Warranty	\$7,738

CODE	TANK OPTIONS	RRP(\$)
PTC06000SG	AquaTrans 6000L - 20 year Warranty	\$9,074

QTY	BAFFLES	RRP(\$)
75	Ball baffles supplied not fitted	\$872
75	Ball baffles fitted at factory	\$969

QTY	BAFFLES	RRP(\$)
100	Ball baffles supplied not fitted	\$1,163
100	Ball baffles fitted at factory	\$1,293

QTY	BAFFLES	RRP(\$)
125	Ball baffles supplied not fitted	\$1,454
125	Ball baffles fitted at factory	\$1,617

QTY	BAFFLES	RRP(\$)
150	Ball baffles supplied not fitted	\$1,745
150	Ball baffles fitted at factory	\$1,940

CODE	STEEL MOUNTING FRAME	RRP(\$)
ASFC03000	with Pump Plate - forklift pockets	\$3,705

CODE	STEEL MOUNTING FRAME	RRP(\$)
ASFC03000	with Pump Plate - forklift pockets	\$3,705

CODE	STEEL MOUNTING FRAME	RRP(\$)
ASFC05000	with Pump Plate - forklift pockets	\$4,745

CODE	STEEL MOUNTING FRAME	RRP(\$)
ASFC05000	with Pump Plate - forklift pockets	\$4,745

WATER CARTAGE TANKS

tti AquaTrans/Move
MOVING LIQUID SOLUTIONS

www.condorpumps.co.nz | 0508 044 055 | sales@condorpumps.co.nz

All prices exclude GST

See page 17 for steel frame options

7000L

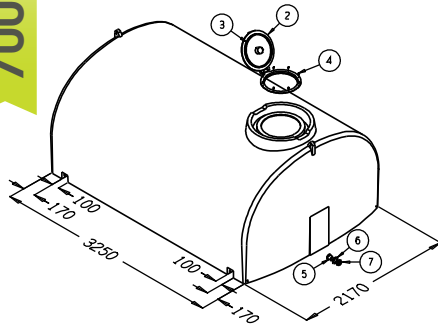

- 2» ø455 Lid Seal Only
- 3» ø455 Lid, Rim, & Seal Assy
- 4» Stainless Steel Screws
- 5-7» 3" MBSP Fitting-Brass
- » 3390(L) x 2250(W) x 1390(H)



8000L

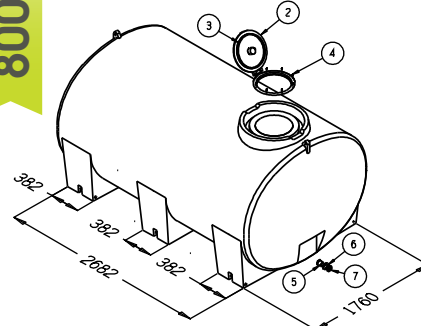

- 2» ø455 Lid Seal Only
- 3» ø455 Lid, Rim, & Seal Assy
- 4» Stainless Steel Screws
- 5-7» 3" MBSP Fitting-Brass
- » 3300(L) x 1900(W) x 1850(H)



10000L

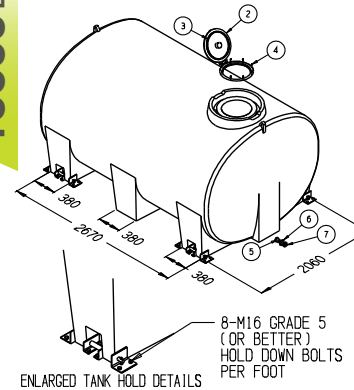

- 2» ø455 Lid Seal Only
- 3» ø455 Lid, Rim, & Seal Assy
- 4» Stainless Steel Screws
- 5-7» 3" MBSP Fitting-Brass
- » 3480(L) x 2250(W) x 1940(H)



13000L

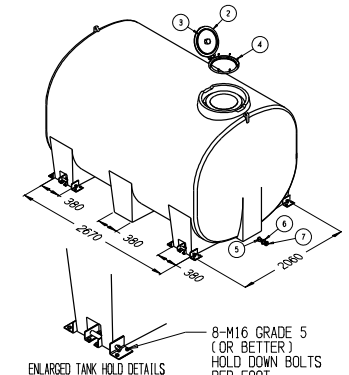

- 2» ø455 Lid Seal Only
- 3» ø455 Lid, Rim, & Seal Assy
- 4» Stainless Steel Screws
- 5-7» 3" MBSP Fitting-Brass
- » 3480(L) x 2250(W) x 2310(H)



CODE	TANK OPTIONS	RRP(\$)
PTC07000SG	AquaTrans 7000L - 20 year Warranty	\$10,307

CODE	TANK OPTIONS	RRP(\$)
PTC08000SG	AquaTrans 8000L - 20 year Warranty	\$12,690

CODE	TANK OPTIONS	RRP(\$)
PTC10000SG	AquaTrans 10000L - 20 year Warranty	\$15,063

CODE	TANK OPTIONS	RRP(\$)
PTC13000SG	AquaTrans 13000L - 20 year Warranty	\$18,101

QTY	BAFFLES	RRP(\$)
175	Ball baffles supplied not fitted	\$2,035
175	Ball baffles fitted at factory	\$2,263

QTY	BAFFLES	RRP(\$)
200	Ball baffles supplied not fitted	\$2,327
200	Ball baffles fitted at factory	\$2,587

QTY	BAFFLES	RRP(\$)
250	Ball baffles supplied not fitted	\$2,909
250	Ball baffles fitted at factory	\$3,234

QTY	BAFFLES	RRP(\$)
325	Ball baffles supplied not fitted	\$3,781
325	Ball baffles fitted at factory	\$4,204

CODE	STEEL MOUNTING FRAME	RRP(\$)
ASFC07000	with Pump Plate - forklift pockets	\$6,310

CODE	STEEL MOUNTING FRAME	RRP(\$)
ASFC08000	with Pump Plate - forklift pockets	\$6,310

CODE	STEEL MOUNTING FRAME	RRP(\$)
ASFC07000	with Pump Plate - forklift pockets	\$6,310

CODE	STEEL MOUNTING FRAME	RRP(\$)
ASFC07000	with Pump Plate - forklift pockets	\$6,310

NEW!

LOW PROFILE TANKS

FEATURES

Impact **resistant**

Low profile for safety

UV stabilised for years of use

Tanks can be drilled and tapped to **accept fittings**

Extra thick wall structure

See **page 17** for **steel frame options**

13000L

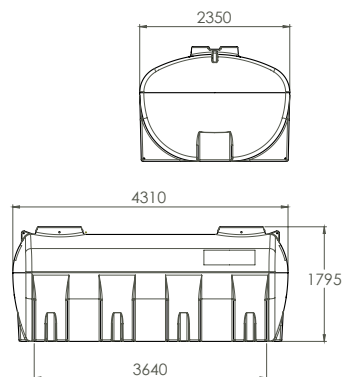

- » ø455 Lid Seal Only
- » ø455 Lid, Rim, & Seal Assy
- » Stainless Steel Screws
- » 3" MBSP Fitting-Brass
- » 4310(L) x 2350(W) x 1795(H)



CODE	TANK OPTIONS	RRP(\$)
PTC13000ASG	AquaTrans 13000L - 20 year Warranty	\$18,101

15000L

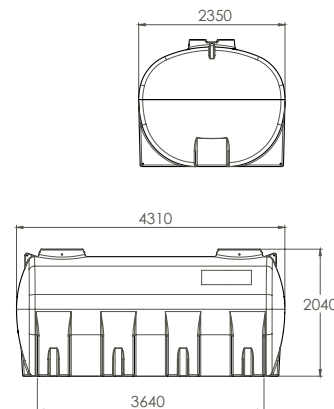

- » ø455 Lid Seal Only
- » ø455 Lid, Rim, & Seal Assy
- » Stainless Steel Screws
- » 3" MBSP Fitting-Brass
- » 4310(L) x 2350(W) x 2040(H)



CODE	TANK OPTIONS	RRP(\$)
PTC15000SG	AquaTrans 15000L - 20 year Warranty	\$20,911

17000L

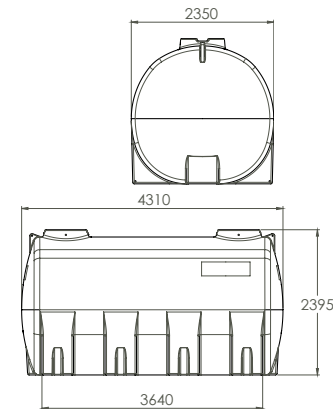

- » ø455 Lid Seal Only
- » ø455 Lid, Rim, & Seal Assy
- » Stainless Steel Screws
- » 3" MBSP Fitting-Brass
- » 4310(L) x 2350(W) x 2395(H)



CODE	TANK OPTIONS	RRP(\$)
PTC17000SG	AquaTrans 17000L - 20 year Warranty	\$23,667

QTY	BAFFLES	RRP(\$)
325	Ball baffles supplied not fitted	\$3,781
325	Ball baffles fitted at factory	\$4,204

CODE	STEEL MOUNTING FRAME	RRP(\$)
ASFC13000	with Pump Plate - forklift pockets	\$7,077

QTY	BAFFLES	RRP(\$)
375	Ball baffles supplied not fitted	\$4,362
375	Ball baffles fitted at factory	\$4,850

CODE	STEEL MOUNTING FRAME	RRP(\$)
ASFC13000	with Pump Plate - forklift pockets	\$7,077

QTY	BAFFLES	RRP(\$)
425	Ball baffles supplied not fitted	\$4,945
425	Ball baffles fitted at factory	\$5,497

CODE	STEEL MOUNTING FRAME	RRP(\$)
ASFC13000	with Pump Plate - forklift pockets	\$7,077

The Toughest Tanks!

OUR **POLY TANKS** ARE AS **TOUGH** AND **DURABLE** AS THEY COME - EVEN AFTER A MISHAP!

CHECK OUT WHAT OUR CUSTOMERS SAID!

"I can't speak highly enough of them. **These guys go above and beyond to help us and our business grow.** I could not recommend a better company to deal with.

- **Fiona Colomb** - Farm City Lidcombe

"I just made an enquiry in regards to a **95 litre 12 Volt Unit with a boom**, I would like to thank you for your **advice, assistance, prompt, efficient** and **excellent service.**

- **Susan**

"Our **RCCF grant recipients** in Stirling North who purchased one of your **800 litre Fire Fighting Units**, recently put it to good use to prevent the spread of a fire on his neighbours' property.

- **Fire & Emergency Services Commission**

"Many thanks Ross. What **fantastic service** you have provided. You've gone above and beyond.

- **Jenny Schwieger**

"We **purchased a TTi** (formerly Rapid Spray Southern) 10,000L tank approx. 8 years ago. Our truck with the tank on it drove over a bridge into a rural property to deliver water and the bridge collapsed, causing the truck to roll. The tank bore the brunt of the impact and we couldn't believe it but, after we righted the truck, the next morning the tank just 'popped' back into shape and away we went again! We also have a 12,000L steel tank (properly made and correctly mounted) and the ongoing maintenance with fatigue and the like is a pain. We would highly recommend a TTi tank to anyone looking to cart water safely!

- **Brett & Linda Harris**
ABC Water Cartage



MOUNTING FRAMES AND PINS



SPECIALLY DESIGNED MOUNTING PINS

Provide the Correct
Strength for Securing
of Your Tank



TO SUIT TANKS FROM 500L TO 1000L

Simple to mount SureFit pin system

Thicker wall steel coupled with unique **hot-dip galvanising** process provides real toughness and corrosion resistant

Frames standard with **forklift pockets** from all **four sides**

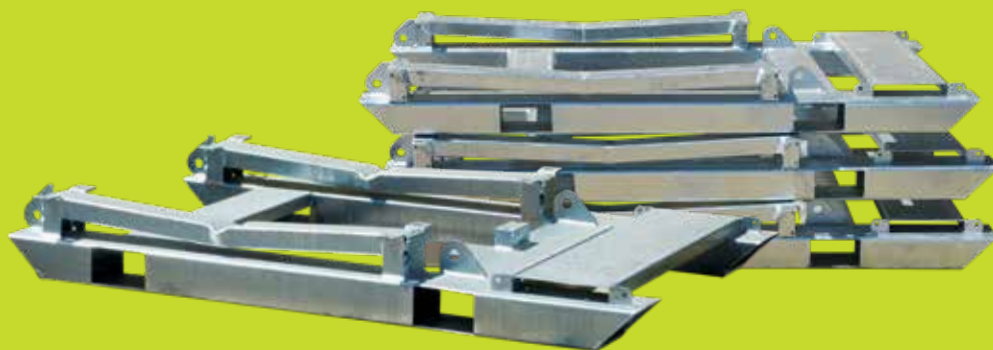

CODE	DESCRIPTION	WEIGHT (kg)	DIMENSIONS (mm)	RRP(\$)
ASFCA00500	Steel Frame for 500L & 600L SumpTrans , includes forklift tine pockets on all sides	37	1840 x 1000	\$2,535
ASFCA00800	Steel Frame for 800L & 1000L SumpTrans , includes forklift tine pockets on all sides	53	2043 x 1070	\$2,736

*Disclaimer: Check compatibility with your forklift width between tynes

CODE	DESCRIPTION	RRP(\$)
ARP001	Set of 4 tank mounting pins 18 x 200mm to suit 500 & 600 Free Standing Tanks & 500, 600, 800 & 1000 Litre Low Profile Tanks	\$74
ARP002	Set of 4 tank mounting pins 18 x 230mm to suit 800 & 1000 Litre Free Standing Tanks	\$93
ARP003	Set of 4 tank mounting pins 18 x 260mm to suit 1200 & 1500 litre Low Profile Tanks	\$93
ARP004	Set of 4 tank mounting pins 24 x 260mm to suit 1200, 1500, 7000 & 9000 Litre Free Standing Tanks & 2000, 2400, 3000 & 4000 Low Profile Tanks	\$105
ARP005	Set of 4 tank mounting pins 24 x 330mm to suit 2000, 2400, 3000 & 4000 Litre Free Standing Tanks and 5000 & 6000 Low Profile tanks	\$105
ARP006	Set of 6 tank mounting pins 24 x 480mm to suit 8000 litre Free Standing Tank	\$180
ARP008	Set of 4 tank mounting pins 24 x 480mm to suit 5000, 6000, 10000 & 13,000 Litre Free Standing Tanks and 10000 & 13000 Litre Low Profile tanks	\$141
ARP009	Mounting kit complete to suit tanks which require ARP008 - includes right angle brackets	\$343
ARP012	Set of 8 tank mounting pins to suit 13000, 15000 & 17000 Litre Low Profile Free Standing Tanks	\$375

TO SUIT TANKS FROM 2000L TO 17000L

Forkliftable for easy lift on, lift off convenience

Simple to mount SureFit pin system

Thicker wall steel coupled with unique **hot-dip galvanising** process provides real toughness and corrosion resistant

Choose from tank only **frame** or **frame with pump plate**



CODE	DESCRIPTION	WEIGHT (kg)	DIMENSIONS (mm)	RRP(\$)
ASFC02000	Steel Frame for 2000L & 2400L AquaTrans	190	2910 x 1410	\$2,425
ASFC03000	Steel Frame for 3000L & 4000L AquaTrans	218	3020 x 1355	\$3,705
ASFC05000	Steel Frame for 5000L & 6000L AquaTrans	302	3500 x 1820	\$4,745
ASFC07000	Steel Frame for 7000L, 10000L & 13000L AquaTrans	410	4100 x 2200	\$6,310
ASFC08000	Steel Frame for 8000L AquaTrans	428	4100 x 1844	\$6,310
ASFC13000	Steel Frame for 13000L, 15000L & 17000L AquaTrans	480	5300 x 2200	\$7,077

*Disclaimer: Check compatibility with your forklift width between tynes

SUREFIT
RELIABLE
AND SECURE
PIN MOUNTING
SYSTEM

POSITIVE
BOLT SYSTEM
ALLOWS FLEX
AND STRONG
INTERLOCKING
BETWEEN
MODULES

ORDER
with
BALL BAFFLES
to reduce surge
& INCREASE
STABILITY

Heavy Duty MODULAR TANK SYSTEM

with **Steel Frame & 6" Connections**

Free Standing...

Free standing design allows for mounting to flat deck truck/trailer. Unique 2 x 6" connections between modules for even filling/drainage. Fully baffled every 3000 Litres to minimise surge (ball baffles optional). Low profile design for improved safety

CODE	DESCRIPTION	DIMENSIONS L X W X H (MM)	RRP(\$)
PTMC06000SG	TransLoc 6000L	2400 x 2000 x 1700	\$11,415
PTMC09000SG	TransLoc 9000L	3620 x 2000 x 1700	\$16,641
PTMC12000SG	TransLoc 12000L	4840 x 2000 x 1700	\$21,850
PTMC15000SG	TransLoc 15000L	6060 x 2000 x 1700	\$27,077
PTMC18000SG	TransLoc 18000L	7280 x 2000 x 1700	\$32,281
PTMC21000SG	TransLoc 21000L	8500 x 2000 x 1700	\$37,449
PTMC24000SG	TransLoc 24000L	9720 x 2000 x 1700	\$42,716
PTMC27000SG	TransLoc 27000L	10940 x 2000 x 1700	\$47,916
PTMC30000SG	TransLoc 30000L	12160 x 2000 x 1700	\$53,150



Free standing design



Low profile design



2 x 6" connections



Improved safety

THE ANSWER TO YOUR **CHEMICAL** TRANSPORT NEEDS

Needing to **cart different chemicals** in one load? Read on...

Modules can be plumbed to **drain independently or together!**

- ✓ **No Rust**
- ✓ **Expandable Tank Capacity**
- ✓ **Large Range of Sizes**
- ✓ **Proven Mount System**

Extra Payload **FULLY BAFFLED** (Every 2500 litres)

Exclusive use of polyethylene **eliminates rust problems** and significantly **reduces weight** resulting in increased payload and durability

InterLoc Modular Tank with Steel Frame, & 2" outlet fittings

CODE	DESCRIPTION	DIMENSIONS L X W X H (MM)	RRP(\$)
PTM05000KSG	InterLoc 5000L	2400 x 2000 x 1730	\$11,986
PTM07500KSG	InterLoc 7500L	3620 x 2000 x 1730	\$17,475
PTM10000KSG	InterLoc 10000L	4840 x 2000 x 1730	\$22,943
PTM12500KSG	InterLoc 12500L	6060 x 2000 x 1730	\$28,431
PTM15000KSG	InterLoc 15000L	7280 x 2000 x 1730	\$33,861
PTM17500KSG	InterLoc 17500L	8500 x 2000 x 1730	\$39,321
PTM20000KSG	InterLoc 20000L	9720 x 2000 x 1730	\$44,850
PTM22500KSG	InterLoc 22500L	10940 x 2000 x 1730	\$50,313
PTM25000KSG	InterLoc 25000L	12160 x 2000 x 1730	\$55,807

Modular **TANK** SYSTEM FULLY DRAINABLE

CALL NOW
0508 044 055
TO SECURE YOUR DEAL

OUR TANKS

Have the **most extraordinary impact-resistant qualities** and are impervious to the toughest conditions

Incorporates in-built Tuff-Flex technology to allow real flex to easily handle any work environment

Use **specially blended polyethylene** to handle the **broadest range of liquids** possible from plain water to the harshest chemicals – ask for a copy of our compatibility chart!

This tractor is no match for our tough poly tanks!

Fully Drainable CHEMICAL TANKS

What to look for when selecting a **spray tank**

Basket filter supplied with tanks 200 Litres and larger

Large tank opening for fast, easy filling. Sealed with 455mm lid with labyrinth breather

Easy fill, no spill containment lip on all spray tanks above 500L

Smooth interior and integral sump enables complete evacuation and decontamination of tank

SureFit Safe and secure mounting pin system

Easy to read calibrations for measurement of contents (coloured for catalogue purposes)



Strong and durable, impact resistant, UV stabilised polyethylene

Manufactured from UV stabilised polyethylene specifically formulated for chemical spray

Impervious to most chemicals

Full drainage sump

Available with robust hot-dip galvanised steel mounting frame for correct tank support and ease of mounting

Despite being run over by a heavy John Deere, all it needed was to be pushed back into shape and a quick clean and it was ready to use again.



Tough poly tanks!



Run over by John Deere!



Shape back to reusable!

Now, that's
one tough TANK!

Note: We **don't** recommend you try this with a steel or fibreglass tank!

TTi Chemical Tanks

- » **Smooth-walled interior design** incorporating a fully integrated sump that ensures complete evacuation and decontamination of the tank to maximise liquid usage and simplify cleaning
- » **Are manufactured to dual Australian Standards** (AS2070:1999 and AS4766:2006) making TTi's of the highest quality, toughest & most durable tank on the market
- » **Include a positive draining tank base with sump** providing a flooded suction regardless of terrain
- » Are **impervious to most chemicals**
- » **Heavy duty tanks** with load rating up to 1:3.1 Specific Gravity (SG)
- » **Australian made for Australian conditions**
- » **20 year warranty** - buy with confidence

- | | |
|-----------------------------------|---------------------------------------|
| ✓ Low Profile | ✓ Easy Flow Drainage System |
| ✓ Tuff-Flex Technology | ✓ Quick and Easy to Clean |
| ✓ UV Stabilised Poly Construction | ✓ Supplied with Lid and Filter Basket |
| ✓ Guaranteed Strength | ✓ Supplied with Outlet Fitting |
| ✓ Extra Thick Structure | |

Get the tank in your corporate **COLOUR** see page 12

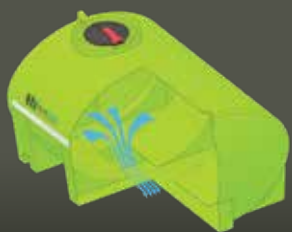

Cutaway shows full drain sump



End view shows sump clearance



Outside view of Pin



Cutaway of tank showing pin mount

Note: Tanks not mounted in **accordance with our specifications** may void warranty



Our frames:

All spray tanks **require a steel mounting frame** to give sumps clearance for access.

Thicker wall steel coupled with our **hot-dip galvanised** process provides real toughness for a long useful life.

Call one of our friendly team today!

0508 044 055

CHEMICAL TANKS

100 L

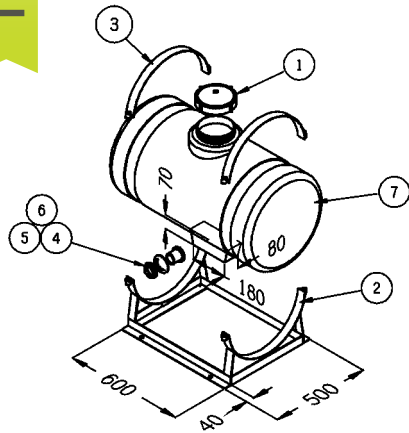

- 1» ø150 Lid Assembly Complete
- 2» Skid Frame Only
- 3» Pair of mounting straps
- 4-6» 1" MBSP Fitting-Poly
- 7» 100 Litre Strap Tank Only



200 L

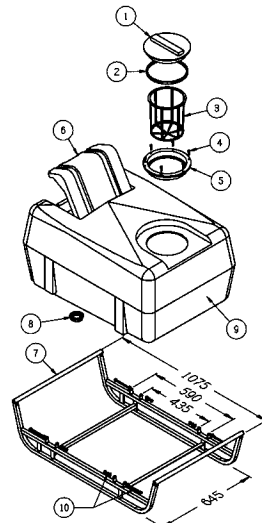

- 1,2,5» ø255 Lid Assembly Complete
- 3» ø255 Filter Basket
- 4» Stainless Steel Screws
- 6» Pump Compartment Cover
- 7» Skid Frame Only
- 8» 3/4" MBSP Fitting-Poly
- 9» 200 Litre Pin Tank Only
- 10» 4 x 8x100mm BSW HED HD Bolt
8 x 8mm washers, 4 x 8mm
nyloc nuts



200 L

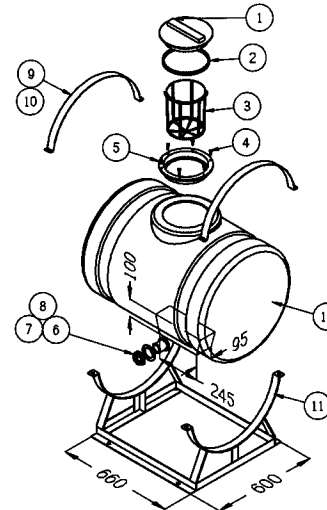

- 1,2,5» ø255 Lid Assembly Complete
- 3» ø255 Filter Basket
- 4» Stainless Steel Screws
- 6-8» 1 1/2" MBSP Fitting-Poly
- 9,10» Straps Only (pair)
- 11» Skid Frame
- 12» 200 Litre Strap Tank Only



300 L

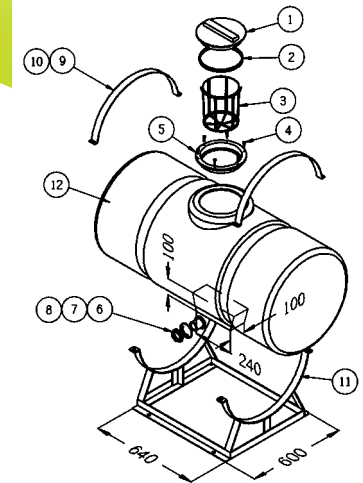

- 1,2,5» ø255 Lid Assembly Complete
- 3» ø255 Filter Basket
- 4» Stainless Steel Screws
- 6-8» 1 1/2" MBSP Fitting-Poly
- 9,10» Straps Only (pair)
- 11» Skid Frame
- 12» 300 Litre Strap Tank Only



CODE	TANK OPTIONS	RRP(\$)
PTSS00100SG	Bare Tank only 815 x 450 x 595 (LWH)	\$574
PTSS00100KSG	Tank with Frame 815 x 450 x 600 (LWH)	\$981

CODE	TANK OPTIONS	RRP(\$)
PTSP00200SG	Bare Tank only 960 x 960 x 550 (LWH)	\$852
PTSP00200KSG	Tank with Frame 1100 x 700 x 656 (LWH)	\$1,090

CODE	TANK OPTIONS	RRP(\$)
PTSS00200SG	Bare Tank only 940 x 600 x 750 (LWH)	\$839
PTSS00200KSG	Tank with Frame 940 x 600 x 760 (LWH)	\$1166

CODE	TANK OPTIONS	RRP(\$)
PTSS00300SG	Bare Tank only 1270 x 615 x 730 (LWH)	\$1040
PTSS00300KSG	Tank with Frame 1270 x 615 x 750 (LWH)	\$1,417

CHEMICAL TANKS

300L

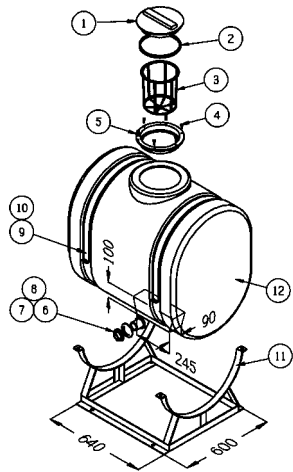

- 1,2,5» ø255 Lid Assembly Complete
- 3» ø255 Filter Basket
- 4» Stainless Steel Screws
- 6-8» 1½" MBSP Fitting-Poly
- 9,10» Straps Only (pair)
- 11» Skid Frame
- 12» 300 Litre Strap Tank Only



400L

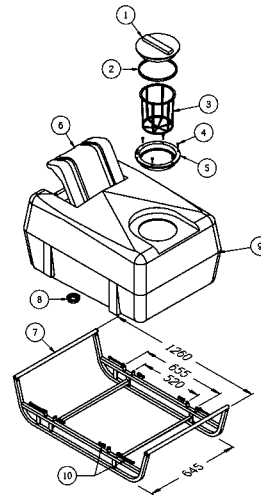

- 1,2,5» ø255 Lid Assembly Complete
- 3» ø255 Filter Basket
- 4» Stainless Steel Screws
- 6» Pump compartment cover
- 7» Skid Frame Only
- 8» ¾" MBSP Fitting-Poly
- 9» 400 litre Pin tank only
- 10» 4 x 8x100mm BSW HED HD Bolt
8 x 8mm washers, 4 x 8mm
nyloc nuts



400L

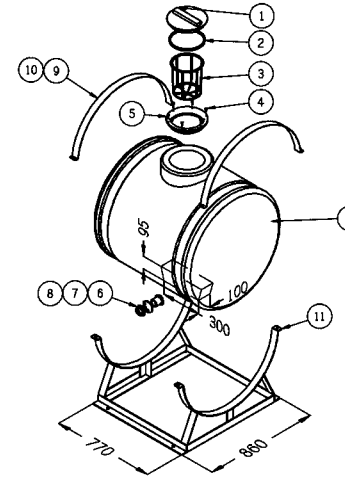

- 1,2,5» ø255 Lid Assembly Complete
- 3» ø255 Filter Basket
- 4» Stainless Steel Screws
- 6-8» 1½" MBSP Fitting-Poly
- 9,10» Straps Only (pair)
- 11» Skid Frame
- 12» 400 Litre Strap Tank Only



500L

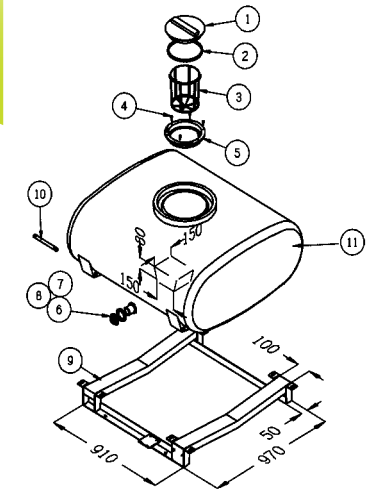

- 1,2,5» ø255 Lid Assembly Complete
- 3» ø255 Filter Basket
- 4» Stainless Steel Screws
- 6-8» 1½" MBSP Fitting-Poly
- 9» Skid Frame Only
- 10» 4 Pins 18 x 200
- 11» 500 Litre LP Tank - Bare



CODE	TANK OPTIONS	RRP(\$)
PTSS00300ASG	Bare Tank only 940 x 600 x 950 (LWH)	\$1,040
PTSS00300AKSG	Tank with Frame 940 x 600 x 965 (LWH)	\$1,417

CODE	TANK OPTIONS	RRP(\$)
PTSP00400SG	Bare Tank only 1145 x 850 x 680 (LWH)	\$1,196
PTSP00400KSG	Tank with Frame 1230 x 850 x 710 (LWH)	\$1,953

CODE	TANK OPTIONS	RRP(\$)
PTSS00400SG	Bare Tank only 890 x 820 x 960 (LWH)	\$1,203
PTSS00400KSG	Tank with Frame 890 x 820 x 975 (LWH)	\$1,976

CODE	TANK OPTIONS	RRP(\$)
PTSP00500SG	Bare Tank only 1250 x 1070 x 590 (LWH)	\$1,350
PTSP00500KSG	Tank with Frame 1250 x 1070 x 630 (LWH)	\$2,151

CHEMICAL TANKS

600L

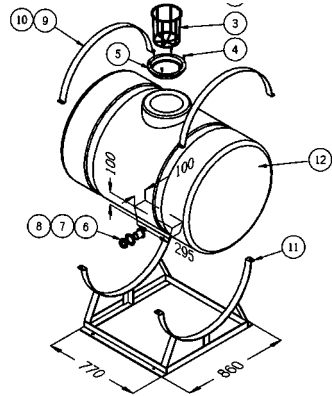

- 1,2,5» ø255 Lid Assembly Complete
- 3» ø255 Filter Basket
- 4» Stainless Steel Screws
- 6-8» 1½" MBSP Fitting-Poly
- 9,10» Straps Only (pair)
- 11» Skid Frame
- 12» 600 Litre Strap Tank Only

600L

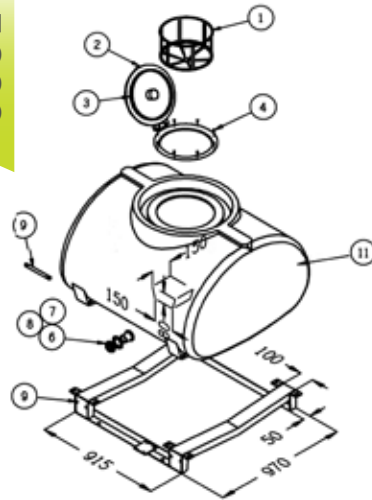

- 1,2,5» ø455 Lid Assembly Complete
- 3» ø455 Filter Basket
- 4» Stainless Steel Screws
- 6-8» 1½" MBSP Fitting-Poly
- 9» Skid Frame Only
- 10» 4 Pins 18 x 200
- 11» 600 Litre Tank - Bare

800L

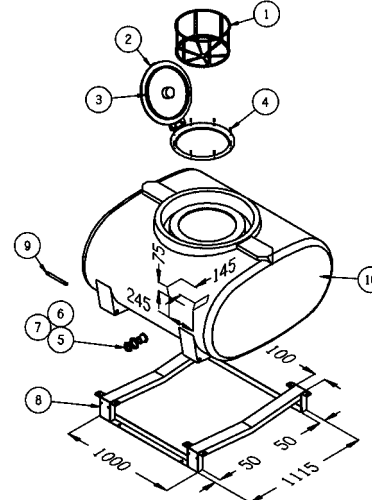

- 2» ø455 Lid, Rim, & Seal Assy
- 1» ø455 Filter Basket
- 4» Stainless Steel Screws
- 5-7» 1½" MBSP Fitting-Poly
- 8» Skid Frame Only
- 9» 4 Pins 18 x 200
- 10» 800 Litre Tank - Bare

1000L

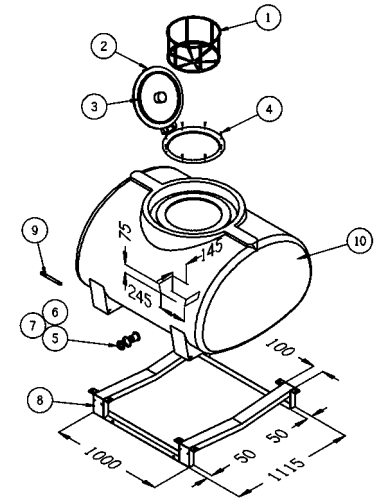

- 2» ø455 Lid, Rim, & Seal Assy
- 1» ø455 Filter Basket
- 4» Stainless Steel Screws
- 5-7» 1½" MBSP Fitting-Poly
- 8» Skid Frame Only
- 9» 4 Pins 18 x 200
- 10» 1000 Litre Tank - Bare



CODE	TANK OPTIONS	RRP(\$)
PTSS00600SG	Bare Tank only 1200 x 840 x 970 (LWH)	\$1,361
PTSS00600KSG	Tank with Frame 1200 x 840 x 1000 (LWH)	\$2,141

CODE	TANK OPTIONS	RRP(\$)
PTSP00600SG	Bare Tank only 1250 x 1070 x 750 (LWH)	\$1,470
PTSP00600KSG	Tank with Frame 1250 x 1070 x 790 (LWH)	\$2,362

CODE	TANK OPTIONS	RRP(\$)
PTSP00800SG	Bare Tank only 1430 x 1220 x 770 (LWH)	\$1,735
PTSP00800KSG	Tank with Frame 1430 x 1220 x 800 (LWH)	\$2,866

CODE	TANK OPTIONS	RRP(\$)
PTSP01000SG	Bare Tank only 1430 x 1220 x 940 (LWH)	\$1,911
PTSP01000KSG	Tank with Frame 1430 x 1220 x 980 (LWH)	\$3,056

CHEMICAL TANKS

1200L

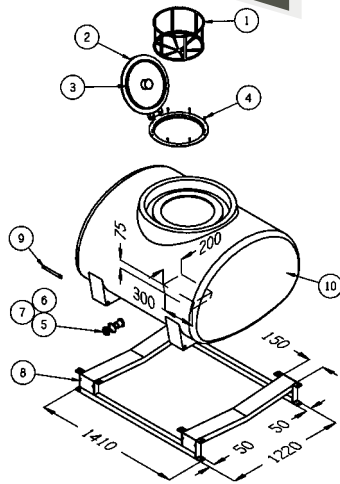

- 2» ø455 Lid, Rim, & Seal Assy
- 1» ø455 Filter Basket
- 4» Stainless Steel Screws
- 5-7» 1½" MBSP Fitting-Poly
- 8» Skid Frame Only
- 9» 4 Pins 18 x 260
- 10» 1200 Litre Tank - Bare



1500L

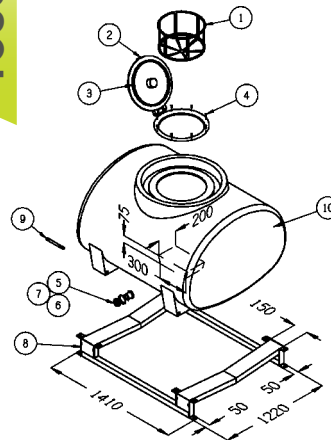

- 2» ø455 Lid, Rim, & Seal Assy
- 1» ø455 Filter Basket
- 4» Stainless Steel Screws
- 5-7» 1½" MBSP Fitting-Poly
- 8» Skid Frame Only
- 9» 4 Pins 18 x 260
- 10» 1500 Litre Tank - Bare



2000L

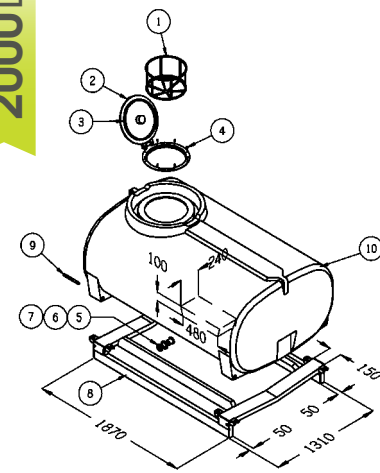

- 2» ø455 Lid, Rim, & Seal Assy
- 1» ø455 Filter Basket
- 4» Stainless Steel Screws
- 5-7» 2" MBSP Fitting-Poly
- 8» Skid Frame Only
- 9» 4 pins 24 x 260
- 10» 2000 Litre Tank - Bare



CODE	TANK OPTIONS	RRP(\$)
PTSP01200SG	Bare Tank only 1700 x 1200 x 950 (LWH)	\$2,190
PTSP01200KSG	Tank with Frame 1700 x 1200 x 990 (LWH)	\$3,513

CODE	TANK OPTIONS	RRP(\$)
PTSP01500SG	Bare Tank only 1700 x 1200 x 1150 (LWH)	\$2,704
PTSP01500KSG	Tank with Frame 1700 x 1200 x 1190 (LWH)	\$4,053

CODE	TANK OPTIONS	RRP(\$)
PTSP02000SG	Bare Tank only 2150 x 1410 x 1150 (LWH)	\$3,447
PTSP02000KSG	Tank with Frame 2150 x 1410 x 1180 (LWH)	\$5,352

All prices exclude GST

CHEMICAL TANKS

6000L

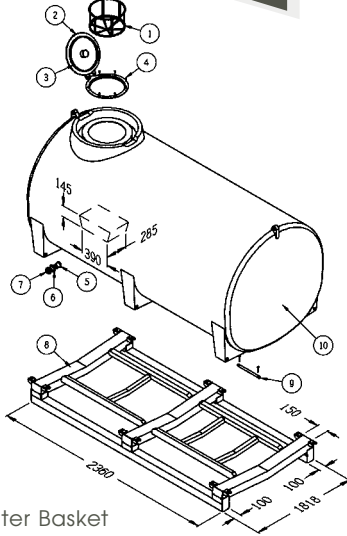

- 1» ø455 Filter Basket
- 2» ø455 Lid, Rim, & Seal Assy
- 3» ø455 Lid Seal Only
- 4» Stainless Steel Screws
- 5-7» 2" MBSP Fitting-Poly
- 8» Skid Frame Only
- 9» 4 Pins 24 x 330
- 10» 6000 Litre Tank - Bare



10000L

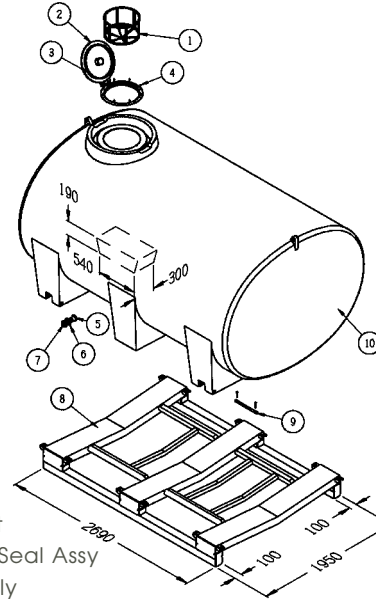

- 1» ø455 Filter Basket
- 2» ø455 Lid, Rim, & Seal Assy
- 3» ø455 Lid Seal Only
- 4» Stainless Steel Screws
- 5-7» 2" MBSP Fitting-Poly
- 8» Skid Frame Only
- 9» 4 Pins 24 x 480
- 10» 10000 Litre Tank - Bare



13000L

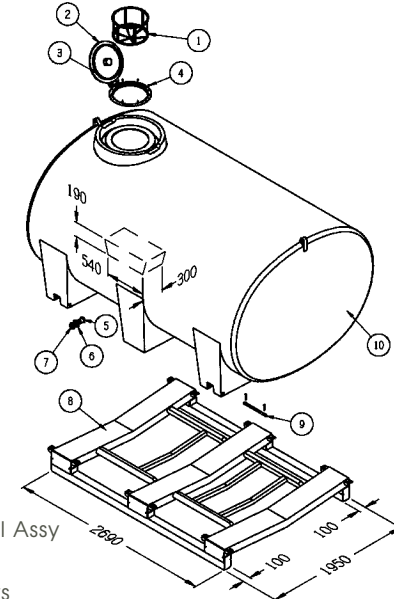

- 1» ø455 Filter Basket
- 2» ø455 Lid, Rim, & Seal Assy
- 3» ø455 Lid Seal Only
- 4» Stainless Steel Screws
- 5-7» 2" MBSP Fitting-Poly
- 8» Skid Frame Only
- 9» 4 Pins 24 x 480
- 10» 13000 Litre Tank - Bare



CODE	TANK OPTIONS	RRP(\$)
PTSP06000SG	Bare Tank only 2760 x 2000 x 1670 (LWH)	\$8,821
PTSP06000KSG	Tank with Frame 2760 x 2000 x 1770 (LWH)	\$12,417

CODE	TANK OPTIONS	RRP(\$)
PTSP10000SG	Bare Tank only 3480 x 2250 x 2050 (LWH)	\$15,064
PTSP10000KSG	Tank with Frame 3480 x 2250 x 2100 (LWH)	\$19,423

CODE	TANK OPTIONS	RRP(\$)
PTSP13000SG	Bare Tank only 3480 x 2250 x 2420 (LWH)	\$18,102
PTSP13000KSG	Tank with Frame 3480 x 2250 x 2470 (LWH)	\$22,461

TANK ACCESSORIES

Selecting a lid for your tank has never been easier.

Simply select the size and choose the style that fits your application.

Add a mesh strainer to provide the first level of filtration protecting your water.

The lids combine high quality, chemical resistant UV stabilised polypropylene construction with a neat appearance making them the ideal choice.

Tank Level Kit

See your tank liquid level at a glance

Code: ARN001

\$54

Hydrant Fill Lid

Ensure your new water cart complies with local regulations by adding this filling option

3" Hydrant Fill Lid

with 1-way valve and camlock
Code: ARH080F

\$2,392

80mm Hydrant Funnel Kit

Fast, top-fill funnel

Code: ARU450F

\$2,243

Brass Tank Outlet Fittings



CODE	DESCRIPTION	RRP(\$)
ARFB025	1" Brass tank outlet	\$66
ARFB032	1¼" Brass tank outlet	\$88
ARFB038	1½" Brass tank outlet	\$105
ARFB050	2" Brass tank outlet	\$130
ARFB080R	3" Brass tank outlet - with Reverse Thread to Prevent Loosening	\$244
ARFB100R	4" Brass tank outlet - with Reverse Thread to Prevent Loosening	\$369

Flanged Poly Tank Outlet Fittings



CODE	DESCRIPTION	RRP(\$)
ARFP020	¾" Tank Outlet - Flanged Poly	\$19
ARFP025	1" Tank Outlet - Flanged Poly	\$19
ARFP032	1¼" Tank Outlet - Flanged Poly	\$22
ARFP038	1½" Tank Outlet - Flanged Poly	\$32
ARFP050	2" Tank Outlet - Flanged Poly	\$39
ARFP050R	2" Tank Outlet - Reverse Thread with 2 Seals Supplied M & F Threads	\$58

Lids & Baskets



CODE	DESCRIPTION	RRP(\$)
ARLP150AV	Female Thread Tank Lid (150mm) - with Spring Breather Valve & Gasket	\$35
ARLP250VSR	Male Thread 'Smoother-Line Lid (255mm) - with Fixed Ring; Labyrinth Double Breather Valve	\$79
ARLP450VSS	Screw Tank Lid (455mm) - with Rim and Seal; Fixed Labyrinth Double Breather Valve	\$140
ARLP450VSR	Hinged Tank Lid (455mm) - with Rim and Seal 180°; with Fixed Ring; Labyrinth Breather Valve	\$140
ARK200	Basket Filter (250mm) - To suit 255mm Lid; 18# Screen 210mm ø x 235mm deep	\$65
ARK400	Basket Filter (450mm) - To suit 455mm Lid; 18# Screen 410mm ø x 235mm deep	\$84
ARB195	Ball Baffles - Small (195mmø) - 1 ball per 7 litre of tank capacity - see p10 for test video	\$6
ARB355	Ball Baffles - Large (355mmø) - 1 ball per 40 litre of tank capacity - see p10 for test video	\$11



DIESEL Equipment

Distributed by
CONDOR

www.condorpumps.co.nz | 0508 044 055 | sales@condorpumps.co.nz



Protect your Investment

Move your Unit Around Easily with **Ergonomic Lifting Handles**



Splash-resistant breather



3/4" or 1" shut off nozzle; Choice of Piusi Italian or DieselFlo Chinese Pump Kits



Earth strap to prevent static build up



4m battery cables with large alligator clips



Choice 6m Piusi or 4m DieselFlo Delivery Hose



Locking latch for lid



Drain Bung



DID YOU KNOW?

All DieselCaptain tanks are moulded with our unique aluminium ring for incredible strength!

This unique multi seal system keeps the rain out and your diesel in



DIESEL REFUELING UNITS

www.condorpumps.co.nz | 0508 044 055 | sales@condorpumps.co.nz

All prices exclude GST



\$ 1,199
100L DieselCaptain
with 40L/min Pump
Code: DUL0100LD040V1



\$ 1,399
200L DieselCaptain
with 40L/min Pump
Code: DUL0200ALD040V1



\$ 1,999
400L DieselCaptain
with 45L/min Pump
Code: DUL0400LF045V1



\$ 2,099
400L DieselCaptain (Slim)
with 45L/min Pump
Code: DUL0400ALF045V1



\$ 1,499
200L DieselCaptain
with 45L/min Pump
Code: DUL0200LF045V1



\$ 2,015
300L DieselCaptain
with 45L/min Pump
Code: DUL0300ALF045V1



\$ 2,303
440L DieselCaptain
with 45L/min Pump
Code: DUL0440LF045V1



\$ 2,399
600L DieselCaptain
with 45L/min Pump
Code: DUL0600LF045V1

LITRES	MODEL & DIMENSIONS	SELECT PUMP	UNIT ONLY ORDER CODE	RRP(\$)
100L	STANDARD 800(L) x 680(W) x 465(H)	40 L/Min	DUL0100LD040V1	\$ 1,199
		45 L/Min	DUL0100LF045V1	\$ 1,483
200L	SPACE SAVER 800(L) x 680(W) x 710(H)	40 L/Min	DUL0200ALD040V1	\$ 1,399
		45 L/Min	DUL0200ALF045V1	\$ 1,499
	LOW PROFILE 1150(L) x 820(W) x 510(H)	40 L/Min	DUL0200LD040V1	\$ 1,399
		45 L/Min	DUL0200LF045V1	\$ 1,599
300L	SLIM DESIGN 1270(L) x 600(W) x 790(H)	40 L/Min	DUL0300ALD040V1	\$ 1,716
		45 L/Min	DUL0300ALF045V1	\$ 2,015
400L	SLIM DESIGN 1270(L) x 600(W) x 990(H)	40 L/Min	DUL0400ALD040V1	\$ 1,883
		45 L/Min	DUL0400ALF045V1	\$ 2,099

LITRES	MODEL & DIMENSIONS	SELECT PUMP	UNIT ONLY ORDER CODE	RRP(\$)
400L	STANDARD 1150(L) x 820(W) x 780(H)	40 L/Min	DUL0400LD040V1	\$ 1,883
		45 L/Min	DUL0400LF045V1	\$ 1,999
		60 L/Min	DUL0400LF060V1	\$ 2,594
440L	LOW PROFILE 1700(L) x 880(W) x 620(H)	40 L/Min	DUL0440LD040V1	\$ 2,047
		45 L/Min	DUL0440LF045V1	\$ 2,303
		60 L/Min	DUL0440LF060V1	\$ 2,616
600L	STANDARD 1700(L) x 880(W) x 740(H)	40 L/Min	DUL0600LD040V1	\$ 2,228
		45 L/Min	DUL0600LF045V1	\$ 2,399
		60 L/Min	DUL0600LF060V1	\$ 2,726

Need a bigger capacity?
see over page...



DIESEL REFUELING UNITS

www.condorpumps.co.nz | 0508 044 055 | sales@condorpumps.co.nz

All prices exclude GST

FITTED
WITH
BALL
BAFFLES

DIESELMAJOR with Petrol or 12v Powered Pump

- » Sleek ergonomic design available in three useful sizes, 600, 800 and 1000L
- » Designed to fit across the width of a standard Ute tray
- » Provision for tie down straps to securely fasten tank onto your vehicle
- » Super Strong spring loaded retractable hose reel with 10m x 25mm hose
- » Genuine Honda GX50 motor coupled with 210L/min or Fluid 60L/min 12v pump for high performance diesel transfer

with Petrol Pump

600L DieselMajor
with 210L/min Pump
Code: DUCD0600LHB210
\$5,610

800L DieselMajor
with 210L/min Pump
Code: DUCD0800LHB210
\$5,878

1000L DieselMajor
with 210L/min Pump
Code: DUCD1000LHB210
\$6,146

with 12v Pump

600L DieselMajor
with 60L/min Pump; 10m Reel
Code: DUCD0600LFB060V1
\$5,090

800L DieselMajor
with 60L/min Pump; 10m Reel
Code: DUCD0800LFB060V1
\$5,358

1000L DieselMajor
with 60L/min Pump; 10m Reel
Code: DUCD1000LFB060V1
\$5,626

Note: Steel Frame as optional upgrade

800L DieselCaptain
with 45L/min Pump
and Ball Baffles
Code:
DUL0800LFB045V1
\$3,009

1000L DieselCaptain
with 45L/min Pump
and Ball Baffles
Code:
DUL1000LFB045V1
\$3,226

1200L DieselCaptain
with 45L/min Pump
and Ball Baffles
Code:
DUL1200LFB045V1
\$3,463

DIESELCAPTAIN Large Capacity Tanks Your Refuelling Partner!

These **contractor quality units** have been designed to withstand the most demanding conditions in Australia and around the world. The **extra strong tank wall provides protection** against rough treatment.

- » Fitted with **Ball Baffle Safety System** to eliminate surge and improve safety
- » Large **pump compartment** protects pump and hose from theft and the weather
- » Choice of **45L/min** and **60L/min** pumps
- » **6m of delivery hose** for extra long reach
- » **Unique breather design** prevents diesel from splashing out of the tank.

LITRES	MODEL & DIMENSIONS	SELECT PUMP	UNIT ONLY ORDER CODE	RRP(\$)
800L	STANDARD 1700(L) x 1000(W) x 860(H) WITH BALL BAFFLE SYSTEM	45 L/Min	DUL0800LFB045V1	\$3,009
		60 L/Min	DUL0800LFB060V1	\$3,325
1000L	STANDARD 1700(L) x 1000(W) x 1025(H) WITH BALL BAFFLE SYSTEM	45 L/Min	DUL1000LFB045V1	\$3,226
		60 L/Min	DUL1000LFB060V1	\$3,542
1200L	STANDARD 1700(L) x 1000(W) x 1190(H) WITH BALL BAFFLE SYSTEM	45 L/Min	DUL1200LFB045V1	\$3,463
		60 L/Min	DUL1200LFB060V1	\$3,777

DIESEL SERGEANT REFUELLING UNITS

- » Flexible suction hose with foot strainer
- » Lockable filler cap for security
- » 4 metres of battery cables
- » Splash resistant breather
- » 4 metres of delivery hose
- » Diesel grade tank
- » Reliable 40 L/min Dieselflo® pump with integrated bypass
- » Auto shut-off nozzle prevents overfilling and fuel wastage
- » Earth strap to prevent static build up when filling tank

WHY
CARRY
JERRY
CANS?

50L DieselSergeant
with 40L/min Pump
Code: DSU0050LD040V1
\$ 913

220L DieselSergeant
with 40L/min Pump
Code: DSU0220LD040V1
\$ 1,322

400L DieselSergeant
with 40L/min Pump
Code: DSU0400ALD040V1
\$ 1,540

Fits where others don't!
The economic space saver

DIESEL CAPTAIN ACCESSORIES

POLYBUND

- » Retains 110% of primary capacity
- » Simple clip-fit lock
- » Intergrated strap mount system
- » Protective spill containment
- » Snug fit to tank reduces water entry to bund
- » Impact resistant UV stabilised poly

Poly Bund

For 400L DieselCaptain Tank
Code: ADB00400OG
\$ 1,058

Steel Frame Options



LITRES	MODEL	FORKABLE FRAME CODE	RRP(\$)
100L	STANDARD	ASFD00100	\$569
200L	SPACE SAVER	ASFD00100	\$569
220L	SQUAT TANK	ASFD00220	\$569
200L	LOW PROFILE	ASFD00200	\$668

LITRES	MODEL	FORKABLE FRAME CODE	RRP(\$)
300L	SLIM Design	ASFD00400	\$668
400L	SLIM Design	ASFD00400	\$668
400L	SPACE SAVER	ASFD00200	\$668
400L	SQUAT TANK	ASFD00400A	\$773
440L	LOW PROFILE	ASFD00440	\$773
600L	STANDARD	ASFD00440	\$773
800L	STANDARD	ASFD00440	\$773
1000L	STANDARD	ASFD00440	\$773
1200L	STANDARD	ASFD00440	\$773

5-Digit Flow Meter Fits to all Diesel units

Measure the Flow
of Your DieselCaptain



5-Digit Flow Meter
Code: ADFPE25D5
\$ 388

**METER FACE
CAN BE
ROTATED 90°**

DIESEL TANKS

Choose from a
Complete Range of

DIESELCADET Without Pump



Breather
System



Strainer



Pad-lockable
Cap



Optional 2" Filler **Camlock**

Sizes from
50 to 10,000 litres

Skid Frame

Need More?



www.condorpumps.co.nz | 0508 044 055 | sales@condorpumps.co.nz

All prices exclude GST



Innovative splash resistant breather system
specifically designed for diesel transport

Earth strap to prevent static build-up; Pad-
lockable filler cap No-spill fill system

Filler cap with strainer; Safety chain to
prevent loss; Pad-lockable cap

Removable plate allows access to tank
2" suction tube access

CODE	CAPACITY (Litres)	DIMENSIONS L X W X H (mm)	RRP(\$)	BAFFLE SYSTEM CODE	BAFFLE SYSTEM RRP(\$)	FRAME CODE	FRAME RRP(\$)
DTC00050L	50	800 x 430 x 390	\$430	N/A	N/A	N/A	N/A
DTC00100L	100	900 x 450 x 475	\$647	N/A	N/A	N/A	N/A
DTC00220L	220	925 x 710 x 510	\$725	N/A	N/A	ASFD00220	\$668
DTC00400AL	400	1620 x 710 x 510	\$1,218	N/A	N/A	ASFD00400A	\$668
DTC00500L	500	1250 x 1070 x 580	\$1,385	DTC00500LB	\$1,788	ASFC00500	N/A
DTC00600L	600	1250 x 1070 x 740	\$1,638	DTC00600LB	\$2,052	ASFC00500	N/A
DTC00800L	800	1430 x 1220 x 670	\$2,018	DTC00800LB	\$2,160	ASFC00800	N/A
DTC01000L	1000	1430 x 1220 x 835	\$2,219	DTC01000LB	\$2,397	ASFC00800	N/A
DTC01200L	1200	1720 x 1230 x 840	\$2,347	DTC01200LB	\$2,796	ASFC01200	N/A
DTC01500L	1500	1720 x 1230 x 1000	\$2,927	DTC01500LB	\$3,198	ASFC01200	N/A
DTC02000L	2000	2150 x 1410 x 870	\$3,851	DTC02000LB	\$4,209	ASFC02000	\$2,425
DTC02400L	2400	2150 x 1410 x 1140	\$4,384	DTC02400LB	\$4,832	ASFC02000	\$2,425
DTC03000L	3000	2430 x 1540 x 1200	\$6,013	DTC03000LB	\$6,548	ASFC03000	\$3,705
DTC04000L	4000	2430 x 1540 x 1450	\$6,919	DTC04000LB	\$7,628	ASFC03000	\$3,705
DTC05000L	5000	2760 x 2000 x 1400	\$8,156	DTC05000LB	\$9,044	ASFC05000	\$4,745
DTC06000L	6000	2760 x 2000 x 1540	\$10,398	DTC06000LB	\$11,464	ASFC05000	\$4,745
DTC07000L	7000	3390 x 2250 x 1390	\$11,050	DTC07000LB	\$12,296	ASFC07000	\$6,310
DTC08000L	8000	3300 x 1900 x 1850	\$13,600	DTC08000LB	\$15,022	ASFC08000	\$6,310
DTC10000L	10000	3480 x 2250 x 1940	\$16,146	DTC10000LB	\$17,924	ASFC07000	\$6,310

DIESEL TANKS

Choose from a Complete Range of

DIESELCADET With Pump

Sizes from 400 to 10000 Litres



www.condorpumps.co.nz | 0508 044 055 | sales@condorpumps.co.nz

All prices exclude GST

HIGH FLOW

60L/min & 80L/min electric pumps

Swivel to prevent hose tangles

Auto shut-off nozzle prevents overfilling & fuel wastage

Diesel pump – Choose from a range of 12, 24 & 240 volt pumps from 40 to 80 L/min flow rate

Bypass valve integrated in pump body

Earth strap to prevent static build up when filling tank

4 metres of electrical cable with battery clips

6 metres delivery hose gives extra reach

With SureFit pin mounting system

IDEAL

For Service Vehicles

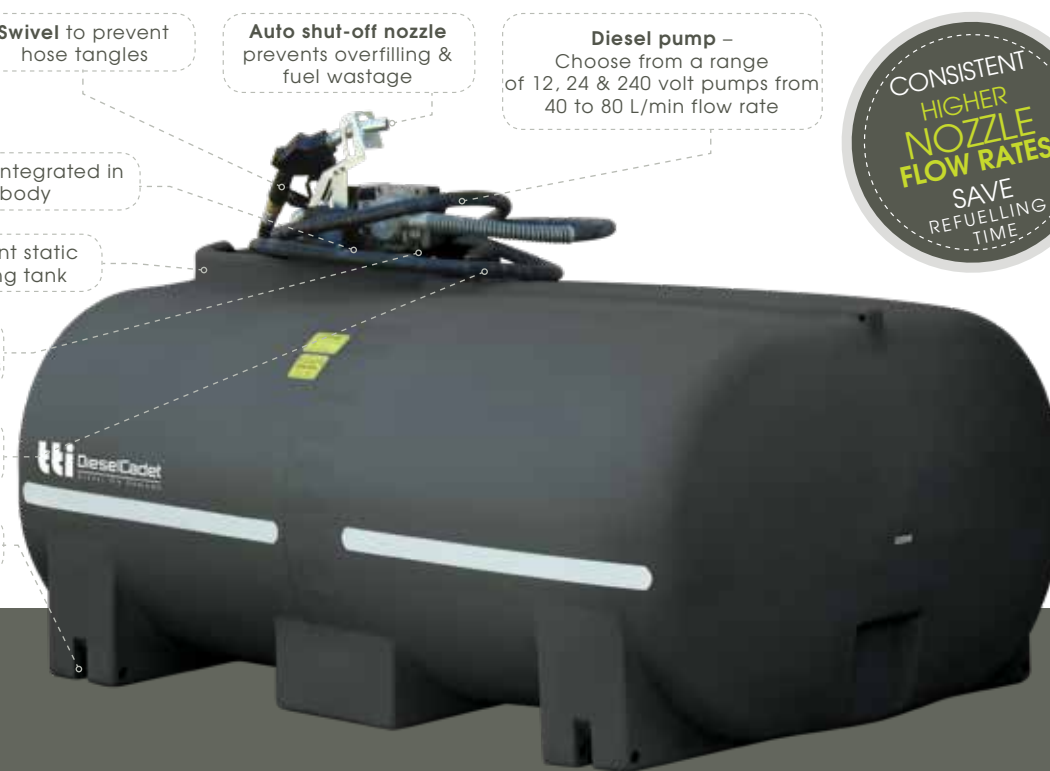

Keep Your Equipment Working with **TTi's on-site Refuellers**

Available: **Forkliftable Steel Frames**



BALL BAFFLES OPTIONAL

CODE	CAPACITY (LITRES)	PUMP	RRP(\$)
DUC0600LF045V1	600	45 L/min	\$2,436
DUC0600LF060V1	600	60 L/min	\$2,702
DUC0800LF045V1	800	45 L/min	\$2,792
DUC0800LF060V1	800	60 L/min	\$3,057

FITTED WITH BALL BAFFLE SAFETY SYSTEM

CODE	CAPACITY (LITRES)	PUMP	RRP(\$)
DUC1000LFB060V1	1000	60 L/min	\$3,459
DUC1200LFB060V1	1200	60 L/min	\$3,849
DUC1500LFB060V1	1500	60 L/min	\$4,243
DUC2000LFB060V1	2000	60 L/min	\$5,097
DUC2400LFB060V1	2400	60 L/min	\$5,749
DUC3000LFB060V1	3000	60 L/min	\$7,017
DUC4000LFB060V1	4000	60 L/min	\$8,635
DUC5000LFB060V1	5000	60 L/min	\$10,037
DUC6000LFB060V1	6000	60 L/min	\$12,435



Cartridge Filters
Code: ADC30M25F
\$157



Flow Meters
Code: ADFMM25D4
\$354



Retractable Hose Reel
Code: ADHR010M25
\$1,933



Aluminium Toolbox
Code: AXMT001
\$292

DIESEL TRAILERS

THE FIRST CHOICE

IN MOBILE DIESEL REFUELLING

Our **diesel trailer range** continues to be the first choice across industry for **diesel fuel transport**.

Built to **ADR standards**, the **DieselCadet** is designed to handle all kinds of conditions with our traditional, tough, hard wearing frame, all terrain tyres, hard working Italian made pumps & specially formulated **double certified diesel grade tank**. Also available with AS1940 compliant bunding for **environmental protection**.

THE DIESELPATROL 14 TRAILER

BRING THE FUEL TO YOUR EQUIPMENT

ON-ROAD
AND
ON-FARM
MODELS
AVAILABLE



1000L DieselPatrol 14 (On-Farm Trailer)
with 45L/min Fluid pump;
with lights; **no brakes**
Code: DSRX1000L045V1
\$ 8,799

1000L DieselPatrol 14 (On-Road Trailer)
with 45L/min Fluid pump;
with lights; **with brakes**
Code: DSRQ1000LF045V1
\$ 10,858

SINGLE AXLE DIESELPATROL 15 TRAILERS

HUGE RANGE OF FIT-OUT OPTIONS

Built to **high level ADR requirements**

"Tough Enough" heavy duty steel chassis featuring **hot-dip galvanising** for maximum protection for tough, long term durable performance

Large **15" wheels** with the famous **Landcruiser hub pattern** for strength, maximum ground clearance and excellent manoeuvrability (800L - 3000L)

Specially strengthened **steel mudguards** with rolled edge for **maximum wheel protection**

Greatly improved **puncture resistance** with our **6 ply radial tyres**, which also helps heavy load capability

ON FARM TRAILERS (WITH LIGHTS – NO BRAKES)

CODE	DESCRIPTION	RRP
DRX0600L	On-farm diesel trailer with 600 Litre tank	\$7,995
DRX0800L	On-farm diesel trailer with 800 Litre tank	\$8,681
DRX1000L	On-farm diesel trailer with 1000 Litre tank	\$8,765
DRX1200L	On-farm diesel trailer with 1200 Litre tank	\$8,898
DRX1500L	On-farm diesel trailer with 1500 Litre tank	\$9,428

ON ROAD TRAILERS (WITH LIGHTS AND BRAKES)

CODE	DESCRIPTION	RRP
DRQ0600L	On road trailer diesel with 600 Litre tank	\$9,842
DRQ0800L	On road diesel trailer with 800 Litre tank	\$11,328
DRQ1000L	On road diesel trailer with 1000 Litre tank	\$11,580
DRQ1200L	On road diesel trailer with 1200 Litre tank	\$11,601

See page 82 for **Dual Axle Trailers**



DUAL AXLE DIESELPATROL 15 TRAILERS

HUGE RANGE OF FIT-OUT OPTIONS

2000L DieselPatrol
On-Farm Trailer with 60L/min Pump;
4-Digit Flow meter & Filter
Code: DRXD2000L
\$ 15,593.5



ON FARM TRAILERS (with lights – no brakes)

CODE	DESCRIPTION	RRP
DRXD1200L	Farm sprung dual axle trailer with 1200L tank	\$ 12,335
DRXD1500L	Farm sprung dual axle trailer with 1500L tank	\$ 12,866
DRXD2000L	Farm sprung dual axle trailer with 2000L tank	\$ 13,903
DRXD2400L	Farm sprung dual axle trailer with 2400L tank	\$ 14,436
DRXD3000L	Farm sprung dual axle trailer with 3000L tank	\$ 17,121

ON ROAD TRAILERS (with lights – no brakes)

CODE	DESCRIPTION	RRP
DRQD1200L	On road dual axle trailer with 1200L tank	\$ 17,074
DRQD1500L	On road dual axle trailer with 1500L tank	\$ 17,605
DRQD2000L	On road dual axle trailer with 2000L tank	\$ 19,013
DRQD2400L	On road dual axle trailer with 2400L tank	\$ 20,099
DRQD3000L	On road dual axle trailer with 3000L tank	\$ 21,290

All prices exclude GST | See page 111 for freight costs

1

CHOOSE
the trailer

2

ADD one of these great
pump options
(See page 86 for more details)

CODE	DESCRIPTION	RRP(\$)
ADPF045V1K	Puosi 45L/min Diesel Transfer Pump Kit	\$ 893
ADPF060V1K	Fluid 60L/min Diesel Transfer Pump Kit	\$ 1,185
ADPX210MPK	Honda GX50 210L/min Diesel Transfer Pump Kit	\$ 1,873

3

ADD one or more of
these optional extras

CODE	DESCRIPTION	RRP(\$)
ADC30M25F	Diesel Cartridge Filter with 1" inlet/outlet	\$ 157
ADHR010M25	Spring Loaded Auto-Rewind Reel with 10m x 25mm diesel hose	\$ 1,933
ADFPE25D5	5-Digit Electric Flow Meter with 1" port	\$ 388
ADFMM25D4	4-Digit Mechanical Flow Meter with 1" port	\$ 354

HOW TO ORDER...

DieselPatrol Trailers

0508 044 055

STATE-OF-THE-ART PANTHERPATROL DIESEL TRAILERS

OPTIMUM FUNCTIONALITY AND DESIGN

CHOOSE
FROM
45, 60, 210
& 490 L/min
PUMP KITS

PUMP KIT
COMPLETE WITH
6M
DELIVERY HOSE
& AUTO
NOZZLE



Lid with splash resistant breather,
2" filler tube and earth strap

10 Litre Fresh Water Tank

70 Litre Fresh Water Tank
(or can be use for AdBlue)

Pump kit fitted in
secure toolbox for
protection
(optional - not included in
price)

Heavy-duty
lockable hinged
lid; with protected
toolbox

Excellent ground
clearance

15" wheels with
Landcruiser hub
pattern

Hot-dip galvanised
steel frame

PantherPatrol 1100L (On-Farm Trailer)

Pump not included; see table for
pump options available

Code: DRPX1100L

\$ 10,582

PantherPatrol 1100L (On-Road Trailer)

Pump not included; see table for
pump options available

Code: DRPQ1100L

\$ 13,715

1 PUMP Options

CODE	DESCRIPTION	RRP
ADPX4900ZK	490L/m Petrol driven GX160 Honda pump kit	\$2,535
ADPX210MPK	210L/m Petrol driven GX50 Honda pump kit	\$1,873
ADPF060V1K	60L/m 12 volt pump kit, 6m x 1" delivery hose	\$1,185
ADPF045V1K	45L/m 12 volt pump kit, 6m x 3/4" delivery hose	\$893

2 FLOW METER Options

CODE	DESCRIPTION	RRP
ADFPE25D5	5 digit electronic flow meter, 1" ports	\$388
ADFMM25D4	4 digit mechanical flow meter, 1" Ports	\$354

3 ADDITIONAL Options

CODE	DESCRIPTION	RRP
ADHR010M25	Spring loaded diesel hose & reel with 10m of 25mm hose	\$1,933
ADC30M25F	Diesel cartridge filter	\$157

DIESEL EXHAUST FLUID (DEF)

Dispenser with 35L/min flow rate

Fully enclosed **lockable pump compartment** for security and protection

- » **35L/min** flow rate
- » **Stainless steel lid** and **auto shut-off nozzle** for controlled dispensing
- » **Stainless steel pump** with internal bypass for durability and ease of use
- » **Stainless steel breather** mounted behind lid
- » **4m of electrical cable** with battery clips
- » EPDM **gaskets and seals**
- » Tank manufactured from **urea grade polyethylene** - Diesel Exhaust Fluid (DEF) compatibility
- » **Filler cap** Diesel Exhaust Fluid (DEF) compatible
- » **4 metres** of 19mm flexible **delivery hose**



100L BlueMission

100 Litre with 35L/min Pump and Auto Nozzle
Dim: 800 x 680 x 465 (mm)
Code: DAL0100LT035AV1

\$2,082

200L BlueMission

200 Litre with 35L/min Pump and Auto Nozzle
Dim: 800 x 680 x 710 (mm)
Code: DAL0200ALT035AV1

\$2,303

**ADBLUE
TANKS**

Affordable Bulk AdBlue Transportable Tanks

Enjoy the poly advantage of **No Rust!**

Tanks are **designed to carry the extra weight** of AdBlue

Extra **UV stabilisation** - protects the tank from ever deteriorating in direct sunlight

20-year tank warranty

**Call us Today to Discuss
Your Specific Requirements**



**Available Tank Sizes
1,000L to 30,000L**



WASHDOWN Equipment

Distributed by
CONDOR

www.condorpumps.co.nz | 0508 044 055 | sales@condorpumps.co.nz



2018

Product Catalogue



PORTABLE WASH DOWN

tti FireGuard
EQUIPPED TO DEFEND

220L & 400L FireGuard Units Highly Efficient Portable Fire Fighters

See this product
in action!



- » Handy size **Fire Fighter for rapid response** to fire emergencies
- » **GX50 Honda** motor, **210 L/min FF pump** for fast & reliable flow
- » **18 metres of Fire Hose** with twist action adjustable FF nozzle

220L FireGuard

Honda GX50 with 210L/min Pump
Dim: 925 x 710 x 810 (mm)
Code: SF0220LZ

\$2,408

400L FireGuard

Honda GX50 with 210L/min Pump
Dim: 1620 x 710 x 810 (mm)
Code: SF0400LZS

\$2,675

400L FireCombat Unit Highly Efficient Portable Fire Fighters

- » **GX160 Honda** motor coupled with **1 1/2" Davey** fire fighting pump
- » **Pressure relief valve** and **bypass** to protect pump
- » **Camlock fittings** and **quick fill kit** for filling from external water source
- » **36m x 19mm Fire Hose** with adjustable aluminium nozzle

FireCombat 400L

Honda GX160 with Davey Pump
Dim: 1620 x 710 x 810 (mm)
Code: SF0400LZ

\$3,747



tti OnDeck
EQUIPPED TO DEFEND

Exciting New OnDeck Fire Fighting Unit

300L OnDeck Units Low-Center of Gravity UTV Fire Fighting Unit

- » Designed to suit all larger UTV's
- » Handy size for rapid response - **Low centre of gravity**
- » Suitable for fire fighting, tree watering, washdown and more...
- » Genuine reliable **Honda GX50** motor
- » **210L/min pump** for fast and reliable flow
- » **18m x 19mm fire hose** with twist action fire fighting nozzle
- » **Manual rewind** powdercoated reel
- » **Australian made tank** with **fully draining Sump** for easy cleaning
- » Tough, UV stabilised poly tank, with **20-Year Warranty**

OnDeck UTV Fire Fighting Unit

with GX50; 210L/min Pump
Dim: 1260 x 1000 x 800 (mm)
Code: PFD0300LZS

\$4,524



5L Fresh Water
Tank with Tap

PORTABLE WASH DOWN



www.condorpumps.co.nz | 0508 044 055 | sales@condorpumps.co.nz

All prices exclude GST



Features

UV stabilised polyethylene tank for long life, with **20-year warranty**

Honda GX160 engine with Davey Pump

Low profile design for safety, stability and ease of operation

Liquid Locker baffling system fitted to eliminate surge

6m quick fill suction kit for filling from channels, dams, rainwater tanks etc

Smart easy plumbing allows fast changeover of hoses when filling



Davey Pump

Now Fitted with
Davey Single Impeller Pump!



See this product
in action!



WashDown 600L

Honda GX160 with Davey Pump
Dim: 1700 x 1000 x 990 (mm)
Code: SFD0600LZ

\$5,197

WashDown 800L

Honda GX160 with Davey Pump
Dim: 1700 x 1000 x 1155 (mm)
Code: SFD0800LZ

\$5,328

WashDown 1000L

Honda GX160 with Davey Pump
Dim: 1700 x 1000 x 1320 (mm)
Code: SFD1000LZ

\$5,588

Upgrade Options



\$773

**Forkliftable
Steel Frame**

Code: ASFD00440



\$403

**20m Spring
Rewind Hose Reel**

ADD 'S' TO END OF CODE

SLIP-ON WASH DOWN



www.condorpumps.co.nz | 0508 044 055 | sales@condorpumps.co.nz

All prices exclude GST

IDEAL FOR

FIRE SUPPRESSION, BURNING OFF, PROPERTY PROTECTION, FIRE BREAKS & BACK BURNING



LIFTING LUGS



MOUNTING PINS



ISOLATION VALVE



FULLY DRAINABLE SUMP

CODE	DESCRIPTION (with baffles)	RRP(\$)
PFUS0400LZF	400 Litre Fire Attack Deluxe Unit Dim: 1570 x 870 x 1000 (mm)	\$6,474
PFU0500LZF	500 Litre Fire Attack Deluxe Unit Dim: 1630 x 1250 x 650 (mm)	\$6,692
PFU0600LZF	600 Litre Fire Attack Deluxe Unit Dim: 1630 x 1250 x 770 (mm)	\$6,961
PFU0800LZF	800 Litre Fire Attack Deluxe Unit Dim: 1780 x 1430 x 750 (mm)	\$7,222
PFU1000LZF	1000 Litre Fire Attack Deluxe Unit Dim: 1780 x 1430 x 950 (mm)	\$7,458

Slip-On Wash Down units

Heavy duty **hose reel** with **36m x 19mm hose**, safety locking catch and adjustable twist type aluminum nozzle.

Pressure relief bypass fitted to tank ensures pump remains cool when in operation. Excess pressure returns to tank.

UV stabilised; Heavy-Duty; Fully drainable tank with **20-year warranty**; Light-weight and durable with **Safety Ball Baffle System**

Engineer approved positive **pin mount system** ensures operator safety

4 x lifting eyelets; 150 x 100mm RHS forklift pockets. Units can be lifted from all four sides

GX200 Honda engine coupled with **400L/min Davey Twin Impeller Fire Pump**

- ✓ 100% BAFFLED
- ✓ DIESEL OR PETROL ENGINES
- ✓ AVAILABLE IN VARIOUS SIZES
- ✓ FORKLIFTABLE STEEL FRAME FOR EASY LOADING/UNLOADING



See this product in action!



Upgrade to
20m Retractable Reel
add **\$403**

FreeCall
0508 044 055

SLIP-ON
AQUA PATH

tti AquaPath
EQUIPPED TO DEFEND

www.condorpumps.co.nz | 0508 044 055 | sales@condorpumps.co.nz

All prices exclude GST

AquaPath Water Cartage Units

Tested and Ready to be **Mounted on to any Flat Tray Truck, Tipper and Trailer**

Perfect for
Landscapers



ALL NEW RANGE!

Packed with amazing new features!

- ✓ Heavy duty poly tanks with **20 Year warranty**
- ✓ **Galvanised steel frame** with forklift pockets
- ✓ **Genuine Honda engines** coupled with **Davey Twin Impeller pumps**
- ✓ **Pressure regulator and bypass** to protect pump from overheating
- ✓ **Skid design** allows it to be easily mounted onto any flat tray truck

AquaPath with **GX200 Honda** and **Twin Davey Pump**

CODE	DESCRIPTION	DIMENSION (mm)	RRP(\$)
PFU2000LZ	2000 Litre AquaPath Unit	2910 x 1410 x 958	\$9,761
PFU2400LZ	2400 Litre AquaPath Unit	2910 x 1410 x 1228	\$10,163
PFU3000LZ	3000 Litre AquaPath Unit	3020 x 1540 x 1340	\$12,872
PFU4000LZ	4000 Litre AquaPath Unit	3020 x 1540 x 1590	\$14,287
PFU5000LZ	5000 Litre AquaPath Unit	3500 x 2000 x 1569	\$16,303
PFU6000LZ	6000 Litre AquaPath Unit	3500 x 2000 x 1709	\$18,679
PFU7000LZ	7000 Litre AquaPath Unit	4100 x 2200 x 1559	\$20,218
PFU8000LZ	8000 Litre AquaPath Unit	4100 x 1900 x 2019	\$22,093
PFU10000LZ	10000 Litre AquaPath Unit	4100 x 2250 x 2479	\$28,320

AquaPath Options

Diesel Motor Upgrade

Upgrade to recoil or electric start 4.8 Hp Yanmar Diesel Engine



Yanmar Diesel Engine 4.8hp
Recoil Start Yanmar
Upgrade Price: **\$ 3,055**

Deflector Spray Bars

Upgrade to single or dual deflector spray bars with a choice of manual or electric controls



Dual Deflector Spray Head
with Manual Control
Code: ARY0038BVX2
\$1,192

Extra Hose Reel

Double your efficiency by adding a second hose reel



Heavy Duty Hose & Reel
36m x 19mm Hose
Code: AFHW10B036M19
\$ 897

Hydrant Fill Lid

Ensure your new water cart complies with local regulations by adding this filling option



3" Hydrant Fill Lid
with 1-way valve and camlock
Code: ARH080F
\$2,392

WASH TRAILERS

Multipurpose
Heavy Duty

**Fire Fighting/
Tree Watering Trailers**



FIREPATROL15 | FIRE FIGHTING **SINGLE-AXLE TRAILER**

HITCH & GO CONVENIENCE IN A GREAT VALUE PACKAGE

- » Galvanised steel frame and mudguards with new 15" wheels
- » Durable UV stabilised polyethylene tank
- » Equipped with Honda GX200 engine and Davey Twin Impeller pump, 36 metre fire fighting hose reel with adjustable nozzle
- » Bottom fill kit is standard

PURPOSE
BUILT
SMOOTH
TOWING

OPTIONAL
**DRIBBLE
BAR**

36 metre fire fighting
hose reel with
adjustable nozzle

Pressure bypass hose for
pump protection

Durable UV stabilised
polyethylene tank

6m Quick fill hose
kit with holder

Heavy duty galvanised
steel chassis.
Chequer plate steel
mudguards and tail light
board

Optional Deflector

Rear pump plate
for operator safety

LED Tail lights

New 15" land cruiser
wheels and tyres

1000L FirePatrol15 "On Farm"

Single Axle - Fire Fighting Trailer - No Brakes
Honda GX200; Twin Impeller Davey Pump
Code: PRFX1000LZ

\$ 11,052

1000L FirePatrol15 "On Road"

Single Axle - Fire Fighting Trailer - with Brakes
Honda GX200; Twin Impeller Davey Pump
Code: PRFQ1000LZ

\$ 13,946

What Makes a FirePatrol15 Trailer Unique?

UV stabilised **lightweight poly tank** fitted with **Ball Baffle Safety System**.

Unique tank positioning distributes weight evenly when empty and full.

Reinforced A-Frame drawbar.
100 x 50mm RHS steel.

Extra gussets for added strength

Rear pump plate ensures operator safety. Eliminates chances of operator being trapped between vehicle and trailer.

Filled in **chequer plate mudguards** prevent road grime flicking onto tank.

Large 50mm solid axle with eye-eye springs and 6-stud hubs.

Large 15" wheels with Sunraysia rims ensures smooth towing.

Standard sprung axle farm trailer **with no brakes or** on road model fully equipped **with brakes and lights**

ON FARM TRAILERS (with lights - NO brakes)

CODE	DESCRIPTION (Incl. Fire Fighting kit)	RRP(\$)
PRFX0600LZ	Farm sprung trailer with 600 Litre tank	\$ 9,293
PRFX0800LZ	Farm sprung trailer with 800 Litre tank	\$ 10,671
PRFX1000LZ	Farm sprung trailer with 1000 Litre tank	\$ 11,052
PRFX1200LZ	Farm sprung trailer with 1200 Litre tank	\$ 12,457

ON ROAD TRAILERS (with lights and brakes)

CODE	DESCRIPTION (Incl. Fire Fighting kit)	RRP(\$)
PRFQ0600LZ	On road trailer with 600 Litre tank	\$ 11,801
PRFQ0800LZ	On road trailer with 800 Litre tank	\$ 13,633
PRFQ1000LZ	On road trailer with 1000 Litre tank	\$ 13,946
PRFQ1200LZ	On road trailer with 1200 Litre tank	\$ 15,113

WASH TRAILERS

www.condorpumps.co.nz | 0508 044 055 | sales@condorpumps.co.nz

All prices exclude GST

FIREPATROL14 | FIRE FIGHTING TRAILER

HITCH & GO CONVENIENCE IN A GREAT VALUE PACKAGE

- » 1½" Single Impeller Davey 500L/min fire fighting pump open flow with pressure relief protection
- » Tail, brake, indicator & number plate lights (Road version only)
- » Fire fighting hose reel with 36 metres of 19mm hose
- » GX160 Honda Motor



See this product in action!

UV stabilised polyethylene tank

Return line to tank

Camlock fittings on pump

Road trailers have hydraulic brake system All terrain road tyres

14" wheels with Ford hub pattern

BOTTOM FILL KIT

Bottom fill kit supplied with all FirePatrol units.

Free!



ADD-ON BALL BAFFLES

Australian approved ball baffle safety system

\$323.7

Code: ARB355F x 25PCS



ADD

Deflector Spray Head

Code: ARY0038BV

JUST ADD \$744.9



1000L FirePatrol14 "On Farm"

Single Axle - Fire Fighting Trailer - No Brakes
Honda GX160; Single Impeller Davey Pump
Code: SRFQ1000LZ

\$10,075

1000L FirePatrol14 "On Road"

Single Axle - Fire Fighting Trailer - with Brakes
Honda GX160; Single Impeller Davey Pump
Code: SRFQ1000LZ

\$11,167

PANTHERPATROL | STATE-OF-THE-ART TRAILER DESIGN

Attractive & Functional with
Built-in Toolbox & Fresh Water Tank



See this product
in action!

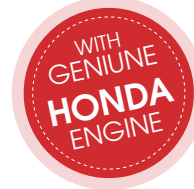

- » **Get the maximum** from your load with this **fully drainable sump tank**
- » **State-of-the-art design**
- » **Engineer approved**
- » Suitable for **use by mining, hire, government departments** and much more...



1100L PantherPatrol "On Farm"
With Lights and No Brakes
Code: PRFPX1100LZ
\$ 12,655

1100L PantherPatrol "On Road"
With Lights and Brakes
Code: PRFPQ1100LZ
\$ 15,429



FIREPATROL15 | FIRE FIGHTING DUAL-AXLE TRAILER

HITCH & GO CONVENIENCE IN A GREAT VALUE PACKAGE

- » Galvanised steel frame and mudguards with new 15" wheels
- » Durable UV stabilised polyethylene tank
- » Equipped with Honda GX200 engine and Davey Twin Impeller pump, 36 metre fire fighting hose reel with adjustable nozzle
- » Bottom fill kit is standard

FULLY
INDEPENDENT
AND
LOAD
SHARING

FANTASTIC
OFF-ROAD
CAPABILITY

ON FARM TRAILERS (with lights - NO brakes)

CODE	DESCRIPTION (Incl. Fire Fighting kit)	RRP(\$)
PRFXD1500LZ	Tandem trailer with 1500 Litre tank	\$15,917
PRFXD2000LZ	Tandem trailer with 2000 Litre tank	\$16,729
PRFXD2400LZ	Tandem trailer with 2400 Litre tank	\$17,329
PRFXD3000LZ	Tandem trailer with 3000 Litre tank	\$19,450

ON ROAD TRAILERS (with lights and brakes)

CODE	DESCRIPTION (Incl. Fire Fighting kit)	RRP(\$)
PRFQD1500LZ	On road trailer with 1500 Litre tank, tandem axle	\$19,652
PRFQD2000LZ	On road trailer with 2000 Litre tank, tandem axle	\$21,905
PRFQD2400LZ	On road trailer with 2400 Litre tank, tandem axle	\$22,295
PRFQD3000LZ	On road trailer with 3000 Litre tank, tandem axle	\$25,337

Fire Fighting Tandem Trailer

For really tough & demanding operating conditions, the Enduro trailer with the simplicity axle system is your best choice! **When the going is really tough, only your tough Enduro Trailer will keep going!**

SPEC UP YOUR FIRE TRAILER WITH THESE OPTIONS



Deflector
spray head



Knapsack fire fighter
& mounting kit



Spare wheel tyre &
mounting bracket



Pintle
Hitch



Diesel
engine

"xTREME" WATER BLASTER TRAILER

Ideal for councils and industrial use, with options such as hot/cold wash for removing heavy grime and dirt.

- » Durable **UV stabilised** polyethylene tank
- » **Petrol or Diesel powered** cold/hot wash pressure cleaner
- » Safety ball baffle system fitted
- » New **15" wheels** and tyres
- » Strong **hot-dip galvanised** heavy duty **steel chassis**
- » **Chequer plate steel mudguards** and tail light board
- » **Rear pump plate** for operator safety
- » **LED tail lights**
- » **Hydraulic override brakes** for improved safety (On-road)



We Can Customise
Your Requirements

0508 044 055



DUST
SUPPRESSION

tti AquaDelivery
DESIGNED • DEPENDABLE • DURABLE

www.condorpumps.co.nz | 0508 044 055 | sales@condorpumps.co.nz

All prices exclude GST

"Reliable" WATER CARTAGE UNITS

Heavy duty water cartage tanks that are specifically formulated for water delivery

- » Tank sizes range from **2000L** to **17000L**
- » **Simple and easy** to use design
- » **20 Year Tank Warranty**
- » Fully **Galvanised Steel Frame**
- » Hydrant-Fill Lid with 3" camlock filling port
- » Choice of **Honda Petrol** or **Yanmar Diesel** Motor



Talk to our water cartage specialists today for more details!

0508 044 055

Turn **your tipper** into a water delivery truck when you need



SEAN TRAILER SALES
AUSTRALIA
PLANET TRAILER

DUST
SUPPRESSION

tti FloodRite
DESIGNED • DEPENDABLE • DURABLE

www.condorpumps.co.nz | 0508 044 055 | sales@condorpumps.co.nz

All prices exclude GST

SERIOUS
STARTER

ALWAYS
READY FOR
ACTION!

"Flash" FLOODRITE UNITS

Heavy duty industrial water carts that are highly customisable

- » 5.5 HP Honda Petrol Motor (*Elec. start*)
- » 3" 1000 L/min Transfer Pump
- » 3" Spray Bar with three 1.5" batter spray heads, in-cab grouped controls
- » Wireless control box with motor on/off and spray bar on/off
- » 20m x 25mm hose and reel
- » Baffle Ball Safety System fitted
- » 3" Hydrant Fill lid (*air gap filler*)
- » 3" Suction fill kit
- » Sight level tube
- » Rotating beacon

APPLICATIONS:
DUST SUPPRESSION
TREE WATERING
ROADS MAINTENANCE
CIVIL WORKS
FIRE FIGHTING
EQUIPMENT WASHDOWN

We Customise to Your NEEDS!

0508 044 055



DUST
SUPPRESSION

tti FloodRite
DESIGNED • DEPENDABLE • DURABLE

SERIOUS
PERFORMER

HIGH VOLUME
APPLICATION
WITH
MEGA FLOW
HEADS

BE SEEN
IN
SAFETY
GREEN

"RAPID FLOOD" WATER CARTS FOR TIPPERS

Heavy duty industrial tanks that are highly **efficient**, **effective**, and **customisable**

- » 13HP Honda Petrol Motor (Elec. start) or 10HP Yanmar Diesel Motor (Elec. start)
- » 3" 1300 L/min Pump
- » Spray bar with 3" centre spray head and 2 x 1-½" outer heads with individual controls
- » In-cab box control with motor on/off and spray bar on/off
- » 3" Pressurised Dribble bar (optional)
- » Baffle Ball Safety System fitted
- » 3" Hydrant Fill lid (air gap filler)
- » 20m x 25mm hose and reel
- » 3" Suction fill kit
- » Sight level tube
- » Rotating beacon

APPLICATIONS:

DUST SUPPRESSION
SOIL CONDITIONING
MINING APPLICATION
CIVIL WORKS
COUNCIL WATERING
WASHDOWN
AND MORE!



10,000L Slip-On FloodRite
in Tipper Body



17,000L Quick Release
Chassis Mount



13,000L with Loading Legs
for Tipper

We Customise to Your NEEDS!



Distributed by
CONDOR





T | 0508 044 055
F | (04) 568 8626
E | sales@condorpumps.co.nz
W | www.condorpumps.co.nz

PO Box 39432, Wellington, New Zealand, 5045

24-26 Downer Street, Lower Hutt
New Zealand 5010A.B.N. 30 165 797 277