

1 Channel Video Server



VS-01A Series

- H.264, MPEG-4 and MJPEG Triple Codec Compression
- Simultaneous Dual stream for Optimized Quality and Bandwidth
- 1 DI/DO for External Alarm and Sensor Device
- 802.3af Compliant PoE
- Built-in SD/SDHC Memory Card Slot for Local Storage
- IEEE 802.11 a/b/g/n Compliance Wireless Connectivity (*)
- WPS Function Support for Easy Wireless Network Setup (*)
- 3D Deinterlace & 3D Noise Reduction

Network Equipments



PS-5881
8-port 10/100M POE Switch



PS-7242IL-AF
24-port 10/100M POE Switch



DWRT-600N
Dual-Band Wireless N Router



3001
PoE Injector

Dimension Diagram (VS-01A Series)

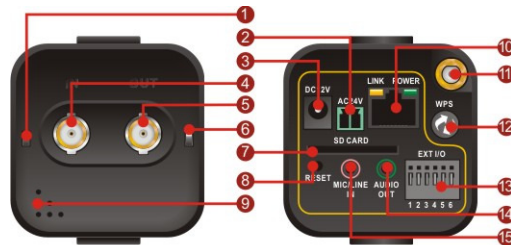

1. Status LED
2. Power Connector (AC24V in) (*)
3. Power Connector (DC12V in)
4. Video Input
5. Video Output
6. WPS LED
7. SD/SDHC Card Slot (*)
8. Reset Button
9. Built-in Microphone
10. Ethernet RJ45 10/100 Socket (Link/Power LED embedded)
11. Detachable Antenna (*)
12. WPS Button (*)
13. Extension I/O Terminal Block
14. Audio Out
15. Microphone/Line In

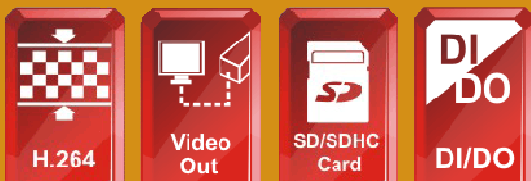
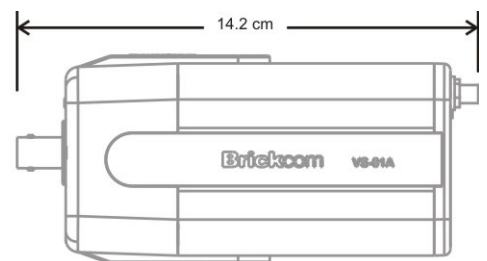
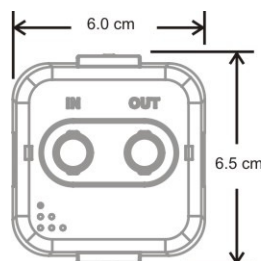

VS-01Ap Series

Camera

Model Number **VS-01Ae**
 NTSC/PAL/ 2 Way Audio/ Ethernet/ POE/
 RS485/ DIDO
VS-01Ap
 NTSC/PAL/ 2 Way Audio/ SDHC/ Ethernet/
 POE/ RS485/ DIDO
WVS-01Ap
 NTSC/PAL / 2 Way Audio/ SDHC/ Ethernet/
 POE/ RS485/ DIDO/ Wireless 802.11 abgn/
 WPS Button

Hardware System CPU: 500 MHz
 Flash: 16M
 RAM: 64M DDR

Video

Video Image Compression H.264 / MPEG4 / MJPEG

Image Resolution **NTSC**
 - 720 x 480
 - 352 x 240
PAL
 - 720 x 576
 - 320 x 288

Frame Rate at Max. Resolution 30fps@NTSC(720x480)
 25fps@PAL(720x576)

Audio

Audio Streaming Two-way audio support

Audio Compression G.711, AMR (8 kHz, Mono, PCM)

Audio Input External microphone or line input (Unbalanced, 1.4 Vp-p, 1 Vrms)

Audio output Line Output

PTZ Protocol Pelco D and P Protocol

Network

Communication Ethernet : one 10/100Mbps RJ-45
 IEEE 802.11 a/b/g/n compliance (**WVS-01Ap**)
 Supported Protocols : TCP/IP, UDP, ICMP,
 DHCP, NTP, DNS,
 DDNS, SMTP, FTP, HTTP, Samba, PPPoE,
 UPnP, RTP, RTSP,
 RTCP, Wireless 802.11 a/b/g/n (**WVS-01Ap**)

General

Front Interface BNC connector (Analog input)
 TV out (Analog output)
 Built-in MIC

Rear Interface & Buttons DC 12V Power In
 AC 24V Power In (**VS-01Ap/ WVS-01Ap**)
 RJ45 Ethernet Cable Connector
 General I/O Terminal Block(DI/DO, RS485 included)
 External MIC/Line Input
 External Audio Output
 Built-in MIC
 Reset Button
 SD/SDHC memory card slot (**VS-01Ap/ WVS-01Ap**)
 WPS Button (**WVS-01A**)
 Detachable Antenna Connector (**WVS-01A**)

Power input AC 24V (**VS-01Ap/ WVS-01Ap**)
 DC 12V / 1A (Power Supply)
 PoE:802.3af Compliant

LEDs **VS-01Ae/VS-01Ap**
 Status/Ethernet (Power/Link)
WVS-01A
 Status/WPS/Ethernet (Power/Link)

Power consumption Max Power Consumption : 10 watts

Environment Operating Temperature : 0°C ~ 50°C (32°F ~ 122°F)
 Operating Humidity : 10% ~ 80%

Dimension 142(L) * 60 (W) * 65(H) mm

Weight **VS-01Ae/VS-01Ap**
 Net: 382g (Without Lens)
 Gross : 812G
WVS-01A
 Net: 392g (Without Lens)
 Gross: 822G

Certification FCC, CE

Warranty Limited 2-year warranty