

Collar Clamp

Stainless Grade 304

Features

- To suit stainless Outside Diameter tube
- Includes stainless fasteners (Metric)
- Collar to suit 5/8" or 16mm Round Bar (Complete with M8 x 12 locking bolt)

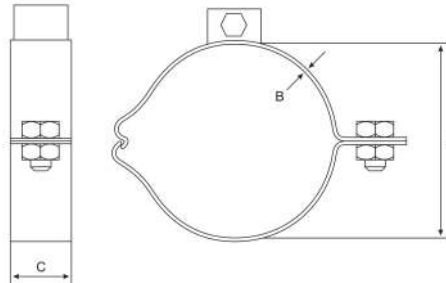

Dimensions - Imperial Tube

Unit: mm (unless stated otherwise)

Size	25.4 1"	31.8 1 1/4"	38.1 1 1/2"	50.8 2"	63.5 2 1/2"	76.2 3"	101.6 4"
A	25.4	31.8	38.1	50.8	63.5	76.2	101.6
B	3	3	3	3	3	3	3
C	25	25	25	25	25	25	25
Code	SCTC25	SCTC30	SCTC40	SCTC50	SCTC65	SCTC75	SCTC100

Fixing Saddle

Stainless Grade 304

Features

- 2x securing points
- To suit stainless Outside Diameter tube

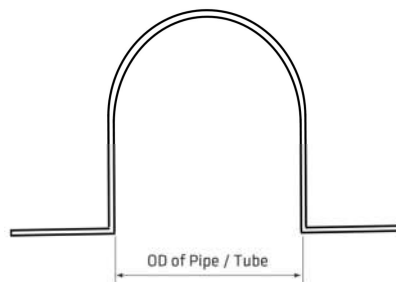

Dimensions - Imperial Tube

Unit: mm (unless stated otherwise)

Size	12.7 1/2"	19.05 3/4"	25.4 1"	31.8 1 1/4"	38.1 1 1/2"	50.8 2"
Code	STS12	STS20	STS25	STS30	STS40	STS50