

Bossed Saddle

Stainless Grade 304

Features

- To suit stainless Outside Diameter tube or Nominal Bore pipe
- Includes stainless fasteners (Metric)
- M10 threaded boss

"Larger saddle sizes available for imperial tube. Refer to page 159"

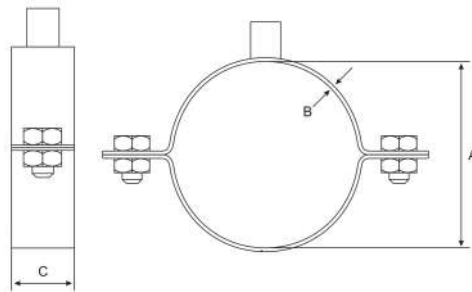

Dimensions - Imperial Tube

Unit: mm (unless stated otherwise)

Size	9.53-12.7 3/8" - 1/2"	15.88 5/8"	19.05 3/4"	25.4 - 101.6 1" - 4"	127 5"	152.4 6"
A	9.53-12.7	5.88	19.05	<i>These sizes are</i>	127	152.4
B	2	2	2	<i>stocked as Clamps.</i>	5	5
C	20	20	20	<i>Refer to opposite</i>	32	40
Code	SBTS0912	SBTS15	SBTS20	<i>page.</i>	SBTS125	SBTS150

Dimensions - Metric Tube

Unit: mm (unless stated otherwise)

Size	15	22	28 - 108
A	15	22	<i>These sizes are</i>
B	3	3	<i>stocked as Clamps.</i>
C	25	25	<i>Refer to opposite</i>
Code	UBTS28	UBTS35	<i>page.</i>

Dimensions - Nominal Bore Pipe

Unit: mm (unless stated otherwise)

Size	15NB 1/2"	20NB - 100NB 3/4" - 4"	125NB 5"	150NB 6"	200NB 8"	250NB 10"	300NB 12"
A	21	<i>These sizes are</i>	141	168	219	273	324
B	2	<i>stocked as Clamps.</i>	5	5	5	6	6
C	20	<i>Refer to opposite</i>	32	32	40	50	50
Code	SBPS15	<i>page.</i>	SBPS125	SBPS150	SBPS200	SBPS250	SBPS300

Stocked Items Non-Stocked Items