

Butt Weld Hosetail

Stainless Grade 316

Features

- Butt welds to Outside Diameter tube sizes
- 150lbs Pressure Rating

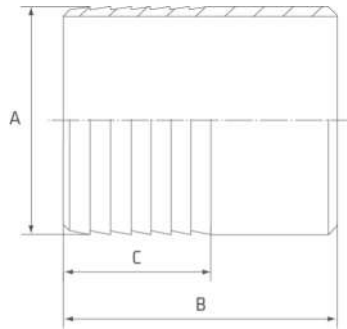

Dimensions

Unit: mm (unless stated otherwise)

Size	6.35 1/4"	9.53 3/8"	12.7 1/2"	19.05 3/4"	25.4 1"	31.8 1 1/4"	38.1 1 1/2"	50.8 2"	63.5 2 1/2"	76.2 3"	101.6 4"
A	6.35	9.53	12.7	19	25.4	31.8	38.1	50.8	63.5	76.2	101.6
B	38	38	45	45	60	60	60	60	70	80	80
C	16	16	30	30	36	36	36	42	44	49.5	55
Thickness	1.6	1.6	1.6	1.6	1.6	1.6	1.6	1.6	1.6	1.6	1.6
Code	SBWH06	SBWH09	SBWH12	SBWH20	SBWH25	SBWH30	SBWH40	SBWH50	SBWH65	SBWH75	SBWH100

Double Hosetail

Stainless Grade 316

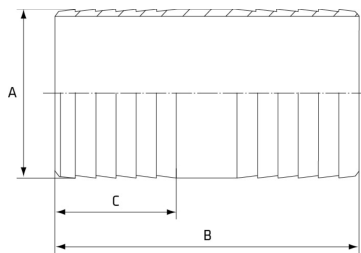

Dimensions

Unit: mm (unless stated otherwise)

Size	6.35 1/4"	9.53 3/8"	12.7 1/2"	19.05 3/4"	25.4 1"	31.8 1 1/4"	38.1 1 1/2"	50.8 2"	63.5 2 1/2"	76.2 3"	101.6 4"
A	6.35	9.53	12.7	19	25.4	31.8	38.1	50.8	63.5	76.2	101.6
B	38	38	75	75	90	90	90	110	120	135	150
C	16	16	30	30	36	36	36	42	44	49.5	55
Thickness	1.6	1.6	1.6	1.6	1.6	1.6	1.6	1.6	1.6	1.6	1.6
Code	SDH06	SDH09	SDH12	SDH20	SDH25	SDH30	SDH40	SDH50	SDH65	SDH75	SDH100